



ELECTRONIC LOCKS

BOA SECURITY TECHNOLOGIES, INC.

Located in Huntington, New York, we originally established our business in 1997 under the name of BOA Handcuff Company, Inc. At that time our business focus was solely our patented High Security Handcuffs for Correctional Facilities worldwide. In 2014 we rebranded our company and began competing for business in the area we all knew best; Retail Cabinet and Showcase Locks. However, we are much more than just a manufacturer, distributor or service provider. We are integrators. We find the best product or mix of products to find solutions for our customers. We take pride in what we do and who we do it for. We do not work on excessive margins as many of our competitors. We work on smaller margins, do a great job and have built our business accordingly. We service some of the best and biggest retailers and correctional facilities in the world and would be proud to add you to our list of happy clients.

WHAT:

Specialized Manufacturer, Distributor and Field Service Provider of Locks used by Retailers for both their showcases as well as interior and perimeter doors.

WHY:

We will save you money and ensure your security via a diversified vendor base with equivalent if not better products and services.

WHERE:

BOA services our clients all through the United States and Canada.

WHEN:

Typical lead times for orders are 7-10 days after receipt of order. Typical response times to “request for service” are within 24 hours. If you require faster service, just tell us so.

Ramp up Time for transferring business to BOA from current vendor is 45 days for BOA to prepare component inventory to meet your immediate needs.

HOW:

Utilizing our extensive inventory of components (either manufactured by us or simply distributed by us), we provide showcase locks and door hardware that meet your specific needs for plug and play replacement or new installations. In addition, our Field Service Tech's are ready to go at a moment's notice anywhere throughout the U.S. and Canada. Just send us an email and we will take the issue off your plate.

CONCEALED CARD ACCESS ELECTRONIC LOCKING SYSTEM



Access control systems enable administrators to control access to secure areas via physical and electronic means. Our products are offered in both offline, online and with wired or wireless solutions. They meet all the challenges posed by a high turnover of people entering or exiting any facility. Our multiple product lines have either been developed by experts in the field and are often expanded on by us to meet specific needs for standalone situations.

Basic System Components:

- Controller
- Power Supply
- Card Reader
- Electronic Locks
- Access Cards

System Features:

- Modular locking system for doors and drawers.
- Low voltage operation - operates on 12VDC.
- Works with individual power supply units or central power supplies with optional battery backup.
- Option for fail safe (unlocks when power is lost).
- Option for fail secure (remains locked when power is lost).
- Slam Function (allows door or drawer to close and secure without requiring unlocking).
- Allows multiple locks to connect with controllers.
- No computer necessary for level or card programming.



#69-KEY-CARD-USER



#69-FT200 CONTROLLER



#69-FT200 CARD READER



#69-EFL-3-304LOCK



#69-EFL-1-3MLOCK
MINI MAG DESIGN FOR CABINETS



#69-MCL-1MAGLOCK
(80 LBS PULL)

CONCEALED CARD ACCESS ELECTRONIC LOCKING SYSTEM



69-FT200 CONTROLLER

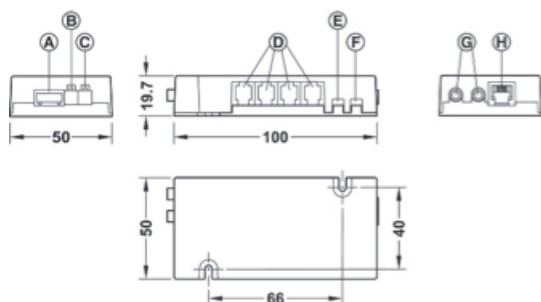

Specifications:

Voltage required:	12-17 VDC or 11-14 VAC
Switching voltage rating:	14V
Current consumption Continuous:	75 mA
Peak:	750 mA
Output extender:	50 mA each
Temperature range (Inside only):	0 °C - 60 °C (32 °F - 140 °F)

Features:

- Up to 228 keys can be authorized at a single terminal.
- Indication of lock state through LEDs (red/green) and audible beep.
- Configurable locking state.
- Cycle operation: Can be configured for 1-120 seconds with optional configuration key card (Pre-set default time 3 seconds).
- Toggle operation: Present key to open, re-present key to lock.
- If an authorized electronic key is presented to the unit, all locks are activated simultaneously.
- Optional output extender: If an authorized electronic key is presented to the unit, independent control of up to 8 electronic locking units is possible.
- Optional LED interface (customer supplied).
- Direct connection of up to 4 EFL 3/EFL 3C
- Connection of 2 antennas
- Extension of functions possible using individual macros

Supplied with:

- (1x) electronic lock controller
- Mounting tabs
- Extension cord 1 m (39-3/8")

#69-FT200 CARD READER

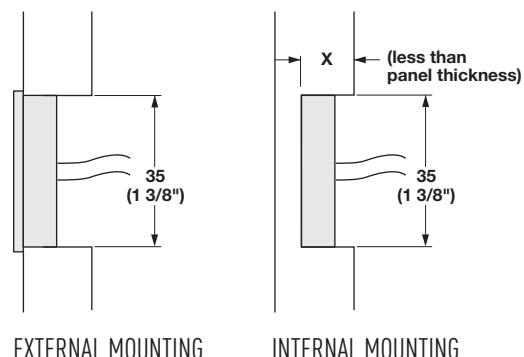
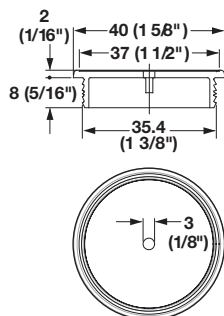
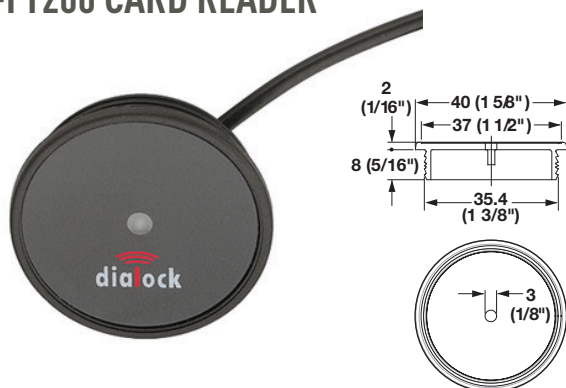

EXTERNAL MOUNTING

INTERNAL MOUNTING

CONCEALED CARD ACCESS ELECTRONIC LOCKS



#69-EFL-3-304 LOCK

Without door status contact

#69-EFL-3-305 LOCK

With door status contact

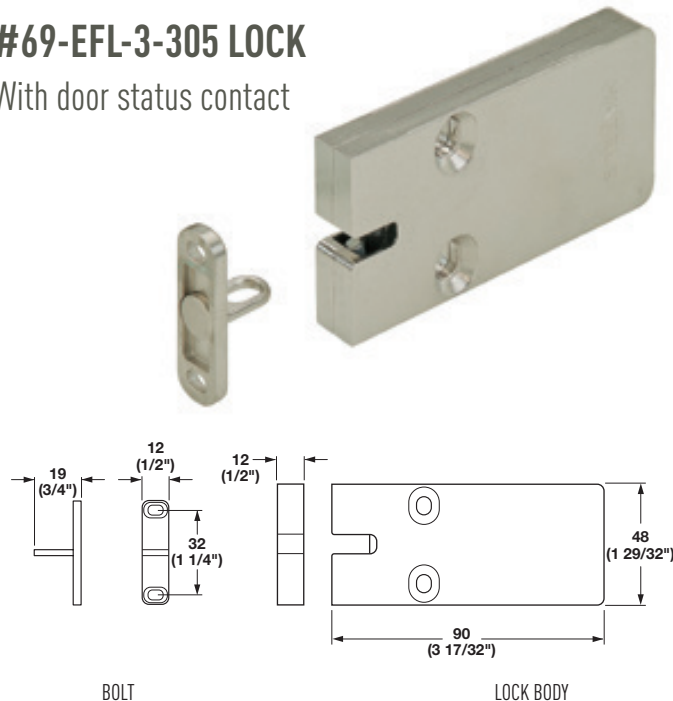

The mounting plate of the locking piece can be installed against a furniture handle on the opposite side (drilling distance: 32 mm (1-1/4")). Multiple EFL3 locks can be connected to the FT120 in parallel (keyed alike). Drill jig required to mount the lock. Marking gauge is recommended to mount the locking pieces.

Features:

- Slam function.
- Fail secure.
- Flat design allows for mounting beneath or beside drawers.
- Electromotive locking mechanism cannot be influenced by magnetic fields.
- Integrated contact "Lock closed/open".
- Optional: Additional contact "locking piece engaged" for door status monitoring.
- Mount with 2x #6 Flat Head screws (not included).

Specifications:

Voltage required:	12VDC \pm 10% (not polarity sensitive)
Current consumption:	
Continuous:	10 mA
Peak:	100 mA for < 40 mS
Duty cycle rating:	Continuous duty (no time limit)
Heat generated:	0.12 Watt
Temperature range:	4 °C - 49 °C (40 °F - 120 °F) 20%-95% RH non condensing
Tensile load limit:	
Locking bolt:	1000 N (225lbf.) holding strength
Min. door width:	200mm (7-7/8")
Connections:	Cables not included

Supplied with:

- (1x) electronic locking unit
- (1x) lock bolt (69-EFL3-BOLT-X)

#69-FT200 PIEZO BUZZER

For acoustic indication of the locking status, for FT 200 furniture terminal, also suitable for customized message alerts such as alarms

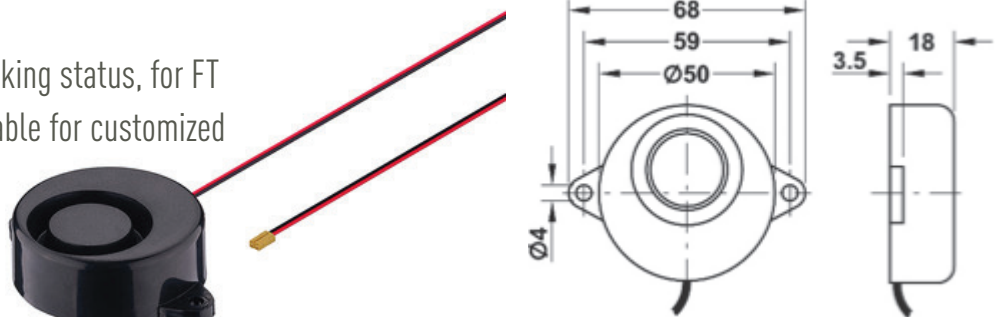

CONCEALED CARD ACCESS ELECTRONIC LOCKS



#69-MCL-1 MINI MAGNET LOCK

Mini design for cabinets.

Must be used in conjunction with the
#69-EXT-RLY external relay unit!

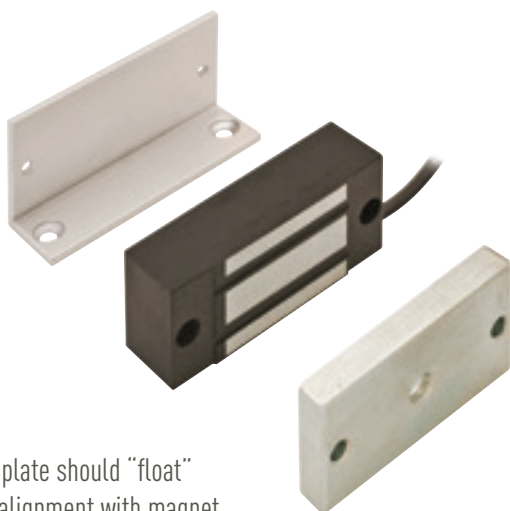

Armature plate should "float"
to allow alignment with magnet.

Specifications:

Physical & performance	at 25 °C (77 °F)
Weight:	400 g (14 oz)
Max. holding load:	364 N (80 lbf.)
Environmental	
Operating temperature:	-15 °C - 40 °C (5 °F - 104 °F)
Storage temperature:	-55 °C - 85 °C (-67 °F - 185 °F)
Humidity (operating):	95% RH at 50 °C (+122 °F)
	Non-combustible
Corrosion resistant finish	
Fluid/Dust resistance	
Electrical	
Voltage required:	12VDC
Power consumption:	< 1.2 W
Continuous Current:	100 mA

Features:

- High tensile load retention.
- Fail safe operation.
- Silent operation.
- Compact and lightweight.
- Flexible mounting options.
- Releases under pre-load.

Supplied with:

- (1x) electronic magnet
- (1x) armature plate
- L-bracket
- Male amp connection (2m Cable)
- Mounting hardware
- Instructions

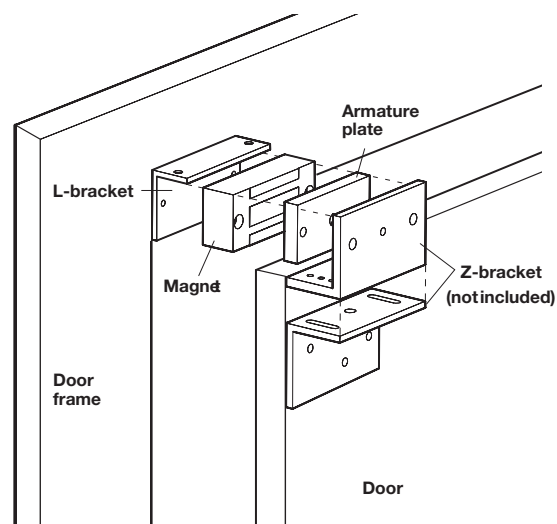
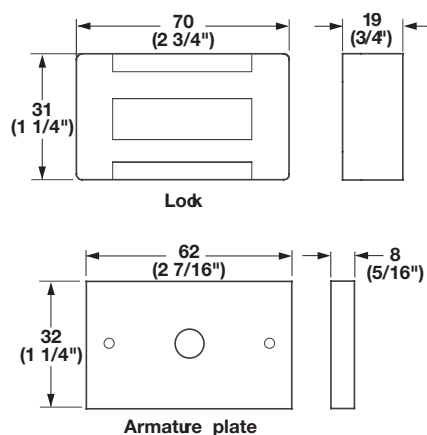

ELECTRONIC LOCKING SYSTEM ACCESSORIES



#69-FT120-MLA6

Multi-Lock Adapter

Enables the user to connect up to 6 EFL3s

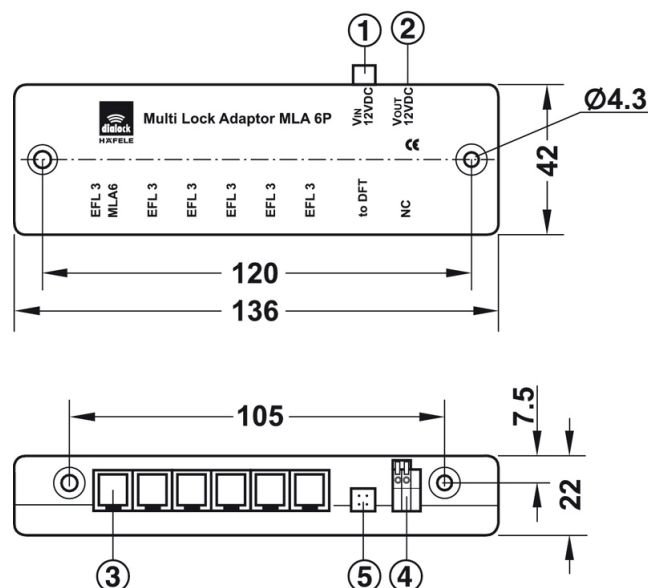
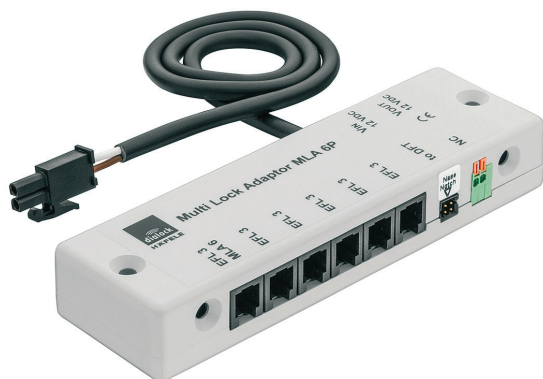

Features:

- Easy wiring of the locks
- Modular connection of the MLA6 to a FT 120 V2 with cable 237.56.340 (included)
- Potential free clamp terminal delivers lock status signal
- Status of the monitoring contacts is available for third party applications such as additional alarm, messages, etc.
- No wiring required to route the EFL3 monitor contacts to the FT 120 V2

Specifications:

Housing dimensions:	136 x 42 x 22 mm 4 x 35 mm or 4 x 55 mm screws (5 3/8" x 1 5/8" x 7/8")
Connection from EFL3 lock:	RJ10
Connection to FT120/B V2:	Molex
Contact rating:	24V, 1A max.
Temperature Range:	0 to 50°C (+32° to +122°F)

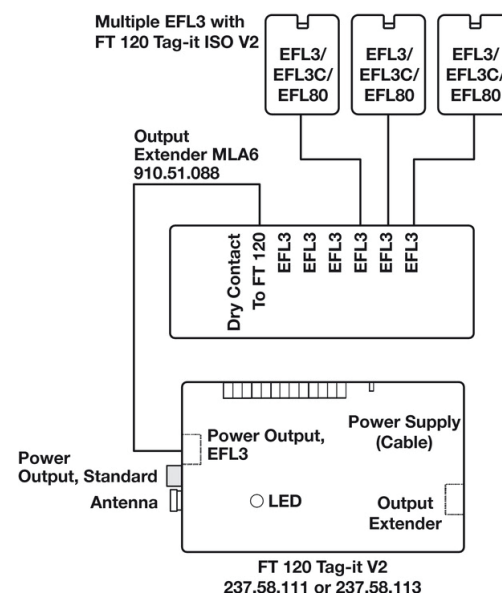

ELECTRONIC LOCKING SYSTEM ACCESSORIES



#69-TRN-12VDC-2.5A

Power Supply



Powered switches reduce lock capacity. The in-line power supplies are not provided with mounting tabs. They are best placed on a protected shelf or trough.

Alternate central power options for large projects in battery back-up power supplies.

Features:

- Protected from damage if the output wiring is shorted

Supplied with:

- (1x) power supply
- AMP socket and 72" primary cord

Specifications:

Housing dimensions:	108 x 58 x 30 mm (4-1/4" x 2-9/32" x 1-3/16")
AC input voltage:	120 V \pm 15%, 47 - 63 HZ
AC input current:	0.6 A
DC voltage output:	12 VDC \pm 5%
Output current range:	0 - 2.5 A
Operating temp. range:	0 °C - 40 °C (32 °F - 140 °F)
Capacity:	max. 50 EFL1 locks

#69-EXT-RELAY

External relay unit



Use in conjunction with FT120
to control MCL1 mag units.

ELECTRONIC LOCKING SYSTEM ACCESSORIES



#69-EFL3-CBL-1M (1 M / 39-3/8")

#69-EFL3-CBL-3M (3 M / 118")

#69-EFL3-CBL-5M (5 M / 196-3/4")

Cables for EFL3(C)



#69-EXT-CBL-1M (1 M / 39-3/8")

#69-EXT-CBL-2M (2 M / 78-3/4")

#69-EXT-CBL-5M (5 M / 196-3/4")

#69-EXT-CBL-10M (10 M / 393-3/4")

Extension Cables



- Used between components on the secondary side (low-voltage side) to the Power Supply.
- 5 and 10 meter extension cables are only for use with locking systems.

#69-DIST-6

Distribution Block 1:6

- Allows up to 6 locks to be connected to one output.
- One male plug wired to 6 female caps.
- For additional locks, a second block can be plugged into one of the caps of the first block (adding 5 locks).
- This process can be repeated as long as the current ratings system, the power supply, and control device (switch) are not exceeded.



EFL SYSTEMS DIALOCK® RFID KEYS TAG-IT™



#69-KEY-TAG-GRY-USER
#69-KEY-TAG-WH-USER

key tags



#69-KEY-TAG-GRN-ADD
#69-KEY-TAG-RD-DEL

Level 1 programming

Add (green) and Delete (red) RFID key tags



- Water-resistant
- 4 Dialock® segments
- WxHxD: 28 x 56 x 1.7 mm (5/8" x 2-1/4" x 1/16")

#69-KEY CARD-USER-WHITE
#69-KEY CARD-ADD USER-GREEN
#69-KEY CARD-DELETE USER-RED



Features:

- Contactless data transmission.
- Read/write transponder.
- No batteries required.
- Insensitive to magnetism, mechanical vibrations, humidity, moisture, & dust.
- Reuseable.
- Forgery proof.

ELECTRONIC LOCKING SYSTEM CONTROLLER / READER UNIT



#69-WT210 CONTROLLER / READER

Wall terminal reader unit and controller in one compact unit.

Allows for installation in flush-mount sockets or cavity wall boxes.



Features:

- Red/green LEDs for indication of locking and unlocking
- Forms a complete offline access point in combination with an electric strike or mag lock.
- Made from plastic, anthracite/silver color.

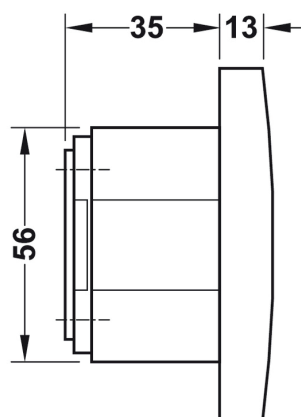
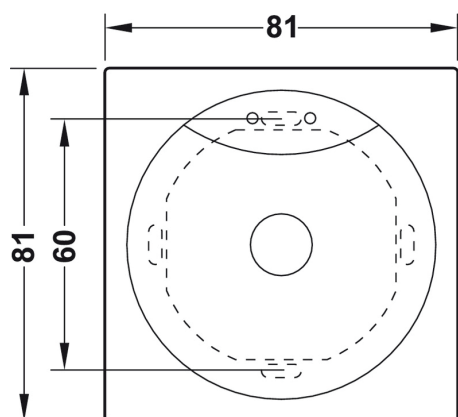

ELECTRONIC LOCKING SYSTEM PROGRAMMING



FIRST TIME POWER-UP PROGRAMMING:

1. Plug-in Power.
2. When the Reader Flashes Green, Introduce the **Green** (add) Card.
3. When the Reader Flashes Red, Introduce the **Red** (delete) Card.

STOP!

PROGRAMMING A USER CARD:

1. Now, present the **Green** (add) Card to the Reader.
2. When the Reader Flashes Green, introduce the White User Card.

STOP! Now Test the Function with a User Key.

CHANGING THE FT 120 OPEN TIME

The steps below assume that the **Green** (add) key, **Red** (delete) key, and User keys have been programmed in the FT 120 unit. If not, then this step is required before changing the open time.

CYCLE MODE

Out of the box the FT 120 is set for an open time of 3 seconds (default). When a valid key is presented to the antenna the FT 120 will keep the lock open for 3 seconds and automatically relock. To change the default time the steps below will require the **Green** (add) programming key and Open Time #74 Transponder. The open time can be adjusted from 1 to 25 (seconds).

1. Present the Open Time #74 transponder to the antenna. The red LED will start flashing.
2. Immediately present the Green key and an audible beep will be heard. Hold the
3. key in place for the desired open time by counting from 1 to 25 seconds.
4. Remove Green key when the desired open time is reach.
5. Test open time with a valid user key.

TOGGLE MODE

Out of the box the FT 120 is set for Cycle mode (if required see Cycle mode above). In Toggle mode a valid key is presented, and the lock opens. A valid key must be presented again; to relock the lock. To configure this mode the steps below will require the **Green** (add) programming key and Open Time #74 Transponder.

1. Present the Open Time #74 transponder to the antenna. The red LED will start flashing.
2. Immediately present the Green key and an audible beep will be heard.
3. Remove Green key immediately after the beep.
4. Test toggle mode with a valid user key.

ELECTRONIC LOCKING SYSTEM PROGRAMMING



MULTI PROGRAM (7A) – SIMPLE PROGRAMMING:

This procedure allows you to create multi **Green** (add) and **Red** (delete) programming keys for simple programming. To proceed with this function at least one **Green** (add) and one **Red** (delete) key must already be enrolled into the lock or controller. The **Green** (add) key already enrolled will serve as the “authorization” key.

Steps below will require the following keys:

- Multi Program (7A)
 - Pre-enrolled green / add – (used to authorize)
 - Additional green / add
 - Additional red / delete
1. Present and remove the Multi Program (7A). Both green and red LED will flash.
 2. Immediately present and remove pre-enrolled green / add to authorize. Green LED will flash.
 3. Immediately present and remove additional green / add key(s)
 4. When all green / add keys have been programmed the flashing green LED will timeout after about 4-5 seconds and immediately start flashing red.
 5. Immediately present and remove additional red /delete key(s)
 6. When all red / delete keys have been programmed the flashing red LED will timeout after about 4-5 seconds and return to a solid red.
 7. Programming is complete.

All programming keys and any unused user key should be stored in a safe location.

INSTALLER NOTE: Since the wire color may change the clip end is generally positive.

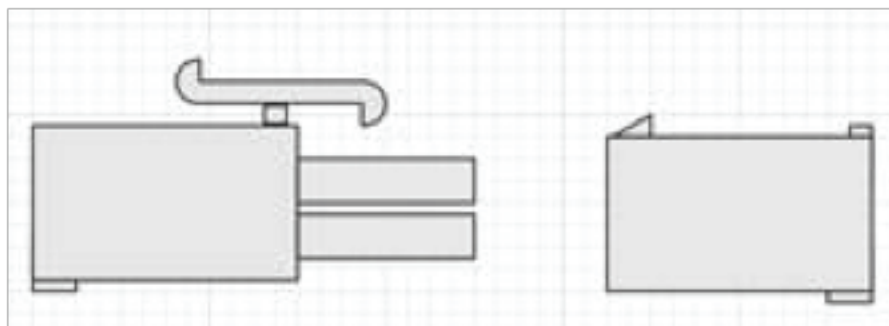

ELECTRONIC LOCKING SYSTEM WALL UNIT WIRING DIAGRAM

HÄFELE dialock

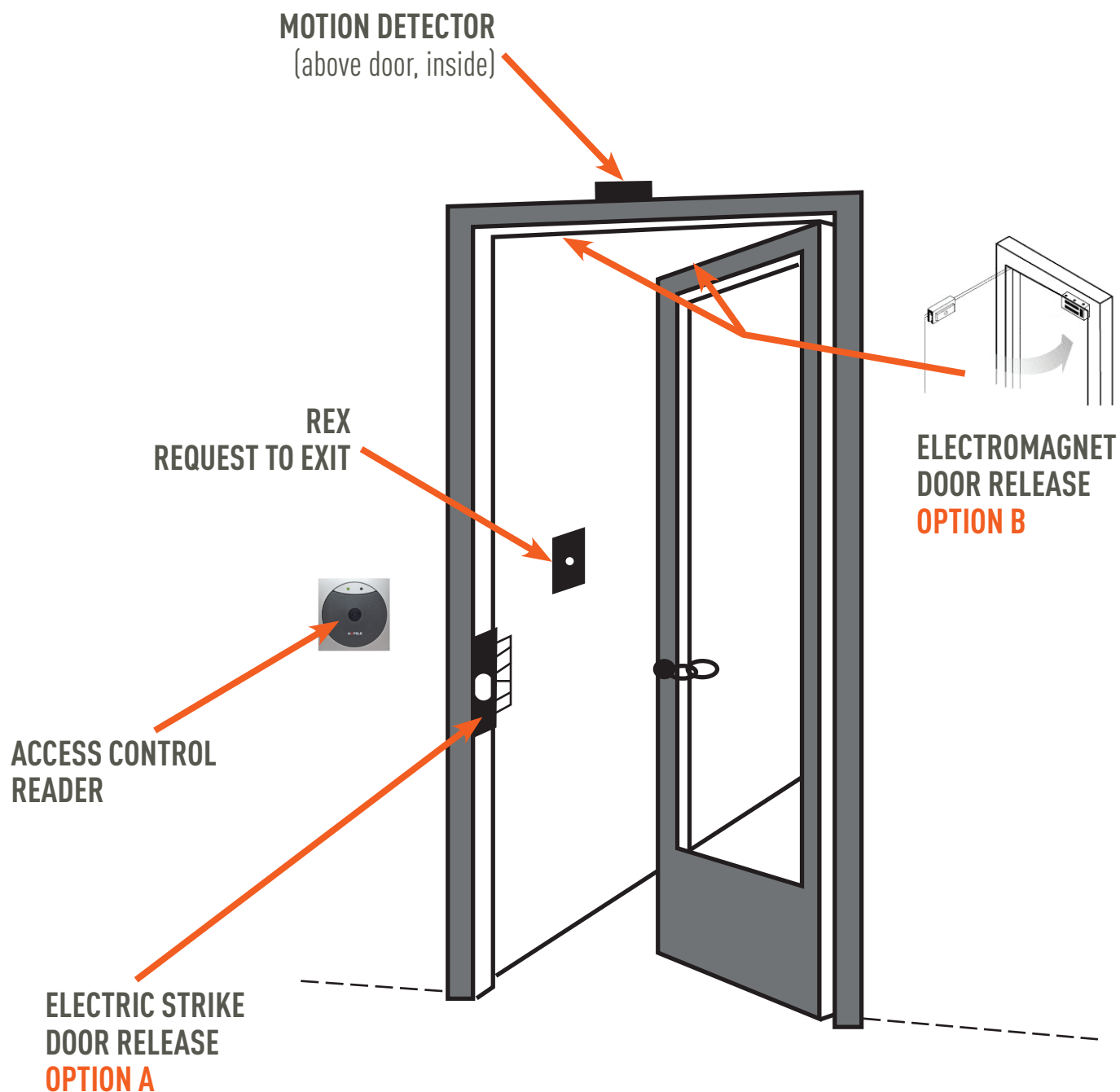

ELECTRONIC LOCKING SYSTEM WIRING DIAGRAMS



BASIC WIRING DIAGRAMS FOR EFL3 LOCKS

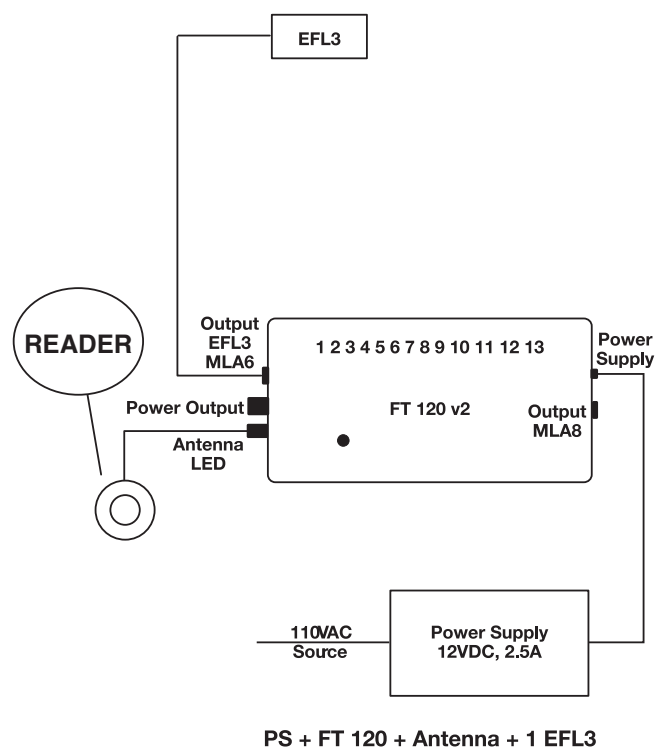

ONE LOCK SETUP

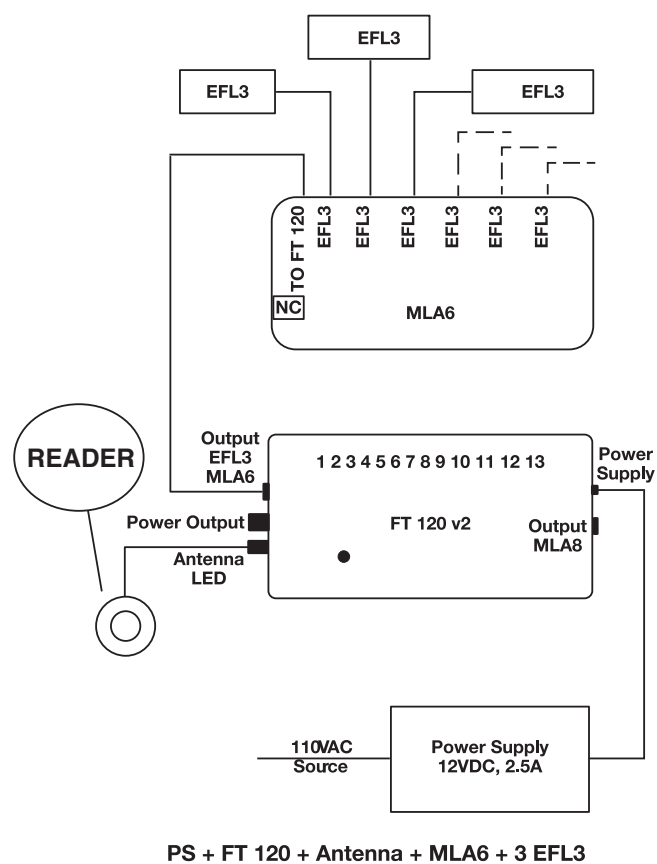

MULTIPLE LOCK SETUP

ELECTRONIC LOCKING SYSTEM STRIKE

#69-STRIKE-ELEC-12/24-FS/NFS

Electric strike for wood and metal frames. Available in various finishes.

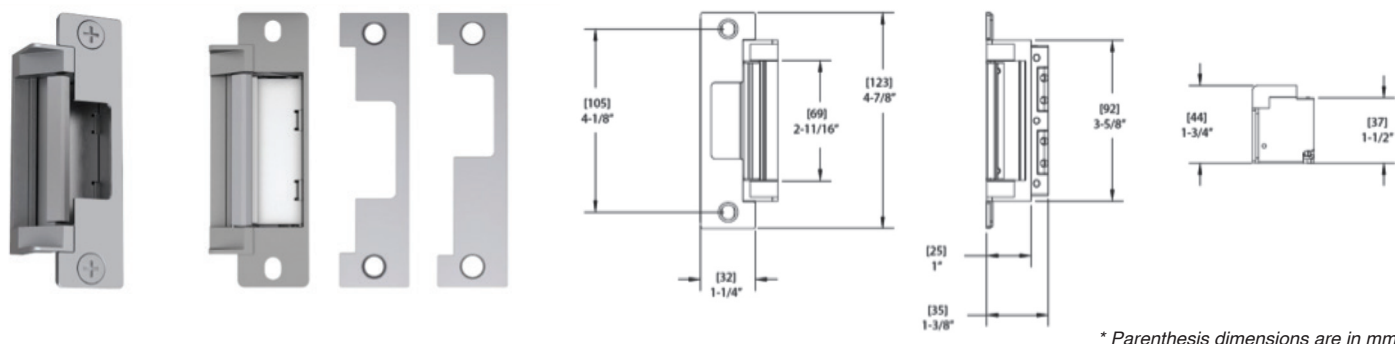

The 4500C series electric strike is designed for installation in 2" UL 10C fire-rated frames with 1/2" drywall penetration. The 4500C features a low profile 1-3/8" depth, heavy-duty stainless steel construction. Its strength is derived from a unique keeper pin locking design, enabling the 4500C to exceed the ratings of the frame, door and locking hardware.

Electrical:

- .24 Amps at 12 VDC/VAC
- .12 Amps at 24 VDC/VAC
- DC continuous duty/AC intermittent duty only

Certifications:

- UL 10C fire rated, 3-hour (fail secure only)
- CAN4-S104 (ULC-S104) fire door conformant
- UL 1034 burglary resistant listed
- UL 294 listed
- ANSI/BHMA A156.31, Grade 1 (#E09321, #E09322, #E09323)
- NFPA-252 fire door conformant
- ASTM-E152 fire door conformant
- California Fire Marshall Listed

The 4500C includes a 4500 strike body and two interchangeable faceplates to accommodate most cylindrical and mortise latch bolts (without deadbolts).

Standard Features:

- Stainless steel construction
- Tamper resistant
- Static strength 1,500 lbs.
- Dynamic strength 100 ft.-lbs.
- Endurance 1,000,000 cycles
- Field selectable fail safe/fail secure
- Dual voltage 12 or 24 VAC/VDC
- Two faceplates provided to accommodate a variety of locksets
- Non-handed
- Internally mounted solenoid
- Accommodates up to a 3/4" latch bolt
- Strike body depth 1-3/8"
- Plug-in connector
- Trim enhancer
- Full keeper shims for horizontal adjustment
- Five-year limited warranty

ELECTRONIC LOCKING SYSTEM

MAGS

#69-MAG-8371-SS

9-3/8"W x 1-7/8"H x 1"D (238mm x 48mm x 25mm)

Includes 3/16" (5mm) mounting bracket Armature Plate: 7-1/4"W x 1-1/2"H x 1/2"D (185mm x 38mm x 13mm)



These Surface Mag® locks are designed with a 1-7/8" width to keep undersized openings within code. These locks are ideal solutions for traffic control on narrow-style interior or perimeter doors. The RCI 8371 Surface Mag® is for single out-swinging doors. Energy: 520mA Field-Selectable 12/24VDC (Max at 12VDC for 8371, 1.04A for 8372)

- Designed to overcome residual magnetism
- Hardened steel armature nut
- Includes 3/8" (9.5mm) armature plate
- Available in Brushed Anodized Aluminum (28) or Brushed Anodized Dark Bronze (40) finish
- UL 294 Special Locking Arrangement Component (6th Edition)
- UL 10C Auxiliary Locks Listed for fire doors rated up to 1-hour
- CAN/ULC S104 Auxiliary Locks Listed for fire doors rated up to 1-hour
- California State Fire Marshal Listed (CSFM: 3774-2127:0100)

Strength:	Up to 750lbf Holding Force
Warranty:	Lifetime Limited Warranty
Mode:	Fail-Safe
Fire-Rated:	CAN/ULC S104 UL 10C 1-Hour
Monitoring:	Optional Door Status Sensor (DSS)/ Security Condition Sensor (SCS) Available

ELECTRONIC LOCKING SYSTEM MAGS

#69-MAG-SHEAR

Securitron SAM Shear Aligning Magnalock



1200 lbs. [544 kg] holding force Shear Aligning Magnalock mounts fully concealed into wood, steel or aluminum doors. SAM can also be installed in any position on the door - top, side or bottom and is ideal for swing through and sliding doors.

Product Features

Features:

- Patented instant release circuit - no residual magnetism
- Fully sealed electronics - tamper proof and weatherproof
- Mounted using steel machine screws
- Architectural brushed stainless steel finish (US32D/630)
- All ferrous metal surfaces plated to MIL specification
- Hardware accessories available to configure any opening type including mounting brackets
- Automatic dual voltage - no field adjustment required
- Lock options include BondSTAT magnetic bond sensor and integrated door position switch
- UL Listed
- MagnaCare® lifetime replacement, no fault warranty

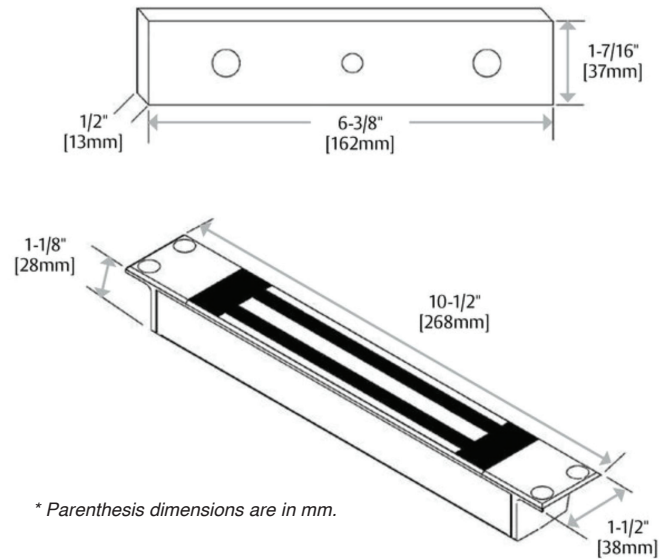

Specification:

- Current Draw and Voltage: 320mA at 12VDC; 170mA at 24VDC
- O L 10C Listed
- UL/cUL GWXT.R13976 /GWXT7.R13976
- UL/cUL FWAX7.SA6635
- UL/cUL FWAX2.SA6635 /FWAX8.SA6635
- UL/cUL ALVY.BP7041
- UL Certificate of Compliance (CoC)
- CSFM 3774-0923:0101
- CSFM 3774-0923:0102
- CSFM 3774-0923:0103
- CAN4-S104, CAN/ ULC-S533 Listed
- ANSI/UL 294 Listed
- ANSI/BHMA A156.23, Grade 1; E08561-1000, E08571-1000, E08581-1000, E08591-1000
- CSFM - California State Fire Marshal Approved
- CE:EN 50081-1(92), EN 61000-6-2(99) Approved
- Operating Temperature: -40 to +140F [-40 to +60C]

ELECTRONIC LOCKING SYSTEM MOTION DETECTOR LOCK RELEASE

#69-RTE-MOTION

For use in request-to-exit (REX) applications.

Complies with Environmental Class II (EN50130-5)



Provides PIR 2.4 m x 3 m (8 ft x 10 ft) coverage, timers, door monitor with sounder alert, and pointable coverage.

Operating Temperature:	-29°C to +49°C (-20°F to +120°F) For UL Certificated installations, 0°C to +49°C (+32°F to +120°F)
Radio Frequency Interference (RFI) Immunity:	No alarm or setup on critical frequencies in the range from 26 MHz to 1000 MHz at 50 V/m
Dimensions:	4.5 cm x 17.1cm x 4.4 cm (1.80 in. x 6.75 in. x 1.75 in.)
Material:	High impact ABS plastic enclosure
Power Loss Default:	Programmable fail-safe or fail-secure modes.
Timer:	Programmable reset accumulative or non-reset counting mode.
Current Draw:	8 mA nominal standby current, 39 mA at 12 VDC in alarm
Voltage:	12 VAC or VDC to 30 VAC or VDC
Alarm Output:	Two Form C relay contacts each rated 1 A at 30 VAC or VDC for resistive loads
Indicators:	1 activation LED

ELECTRONIC LOCKING SYSTEM

REQUEST TO EXIT BUTTON

#69-RTE-BUTTON

991 Pneumatic Time Delay Exit Pushbutton



- Red, 1-5/8" (41mm) diameter button with engraved "PUSH TO EXIT"
- Tamper-resistant, cannot be burned or pried off
- Quickly mounts to single gang box (Standard) or narrow-stile door frames (Narrow)
- 0-45 seconds adjustable time delay
- Made in the USA
- Brushed Stainless Steel (32D) faceplate
- 2 Year Limited Warranty
- Standard: 2-3/4"W x 4-1/2"H (70mm x 114mm)
- Narrow: 1-3/4"W x 4-1/2"H (41mm x 114mm)
- UL 508 recognized microswitch
- Listed to CSA C22.2 NO. 14-10

MEMO SHOWCASE SECURITY SYSTEM DIAMOND[E]MOTION SERIES



The Memo Electronic Card Access Locks consist of the Local Controller, the Card Reader, the Lock(s) and the Power Supply. The Local Controller is the brains of the system.

It permits you to connect up to 8 Locks and 2 Card Readers in order to secure either one or even two showcases using one controller. All connections utilize quick-disconnect plugs for fast, mistake free wiring. The Controller stores the specific serial number of authorized User Cards to grant or deny access.



MEMO SHOWCASE SECURITY SYSTEM DIAMOND[E]MOTION SERIES



#70-CONTROLLER-8/2-M2G

The Local Controller connects to a Card Reader and the Lock that is mounted in the showcase. and It can control up to 8 Locks and 2 Card Readers to allow for a cost effective and secure installation.

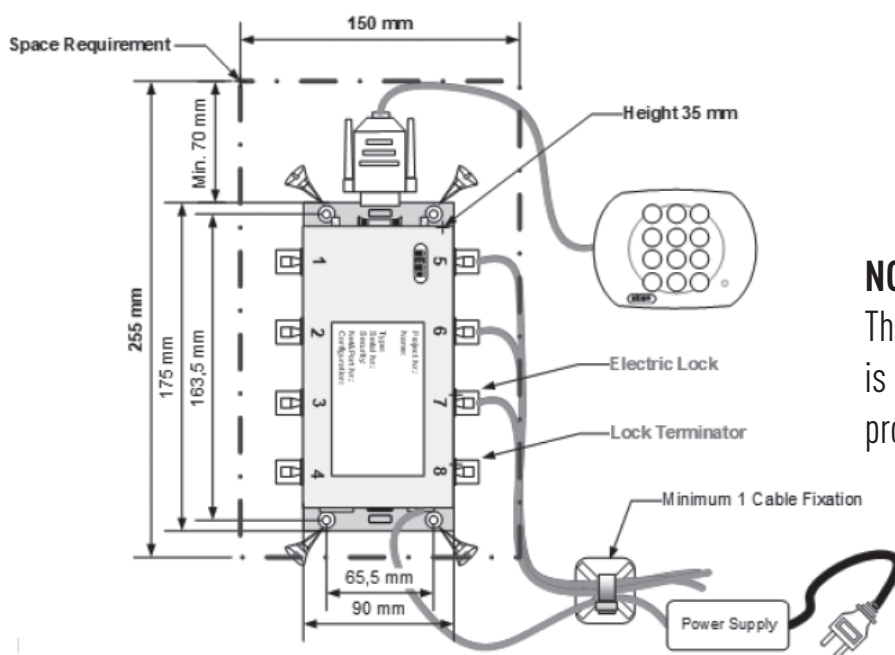
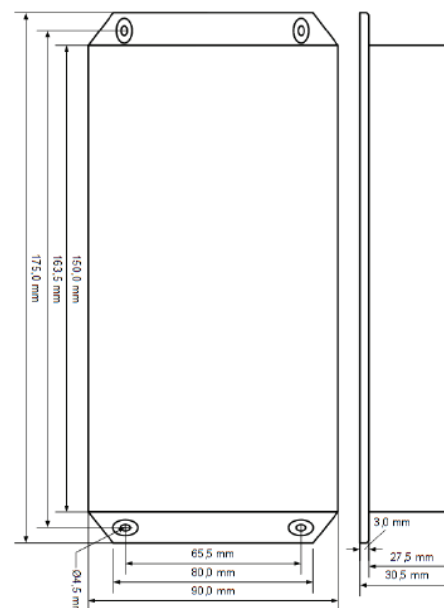

NOTE:

The 12 Button Digital Programmer is only connected on occasion to program certain features.

MEMO SHOWCASE SECURITY SYSTEM DIAMOND[E]MOTION SERIES



#70-LOCK-002

Spring loaded, motorized, fail secure lock with a stainless steel housing and internal components.

Contains a built-in door contact and can, if programmed ensure you are never left unaware that the door is not secure.

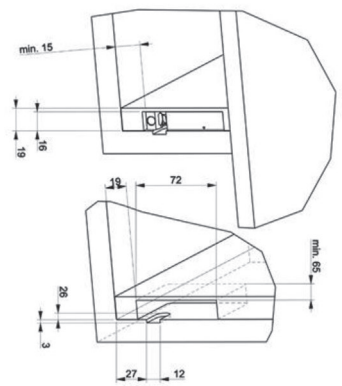
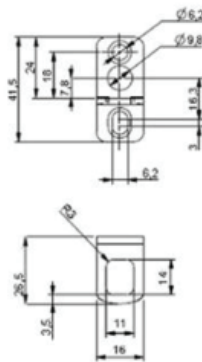
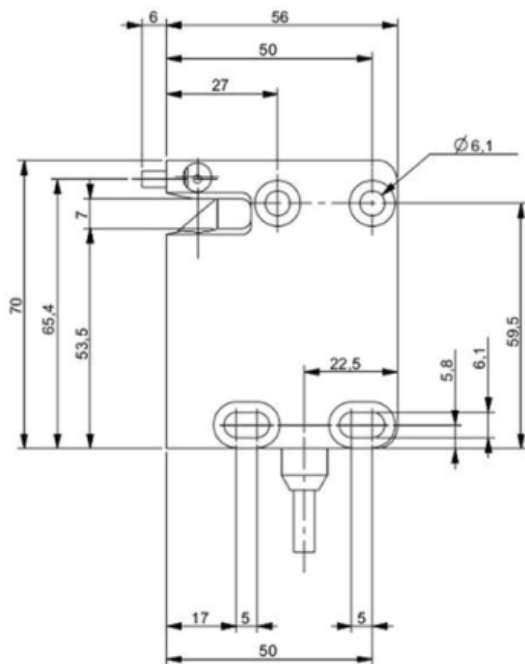
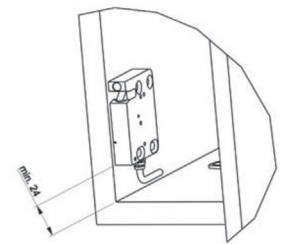
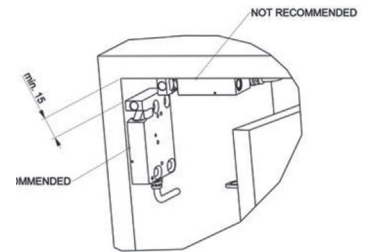

MEMO SHOWCASE SECURITY SYSTEM

DIAMOND[E]MOTION SERIES

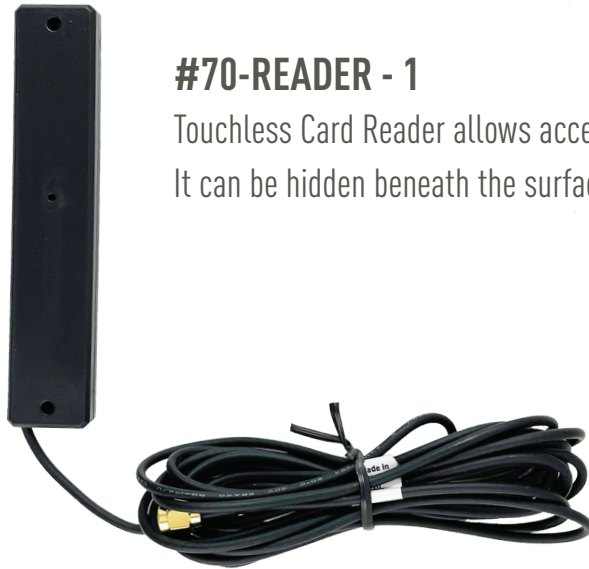

#70-READER - 1

Touchless Card Reader allows access card or fobs to open the showcase.
It can be hidden beneath the surface of the showcase or mounted to it.

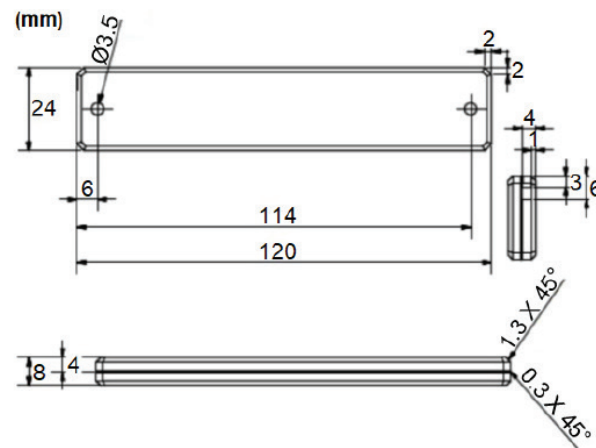

#70-USER FOB

User Fobs and User Cards are programmed to unlock and serve as an electronic key to the showcase.

#70-USER CARD

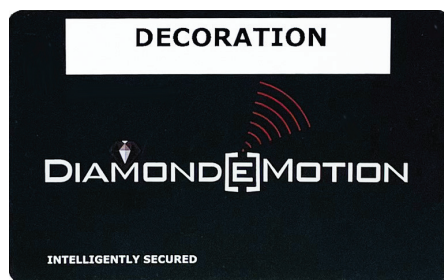

MEMO SHOWCASE SECURITY SYSTEM DIAMOND[E]MOTION SERIES



#70-TRANSFORMER

12-VOLT POWER SUPPLY

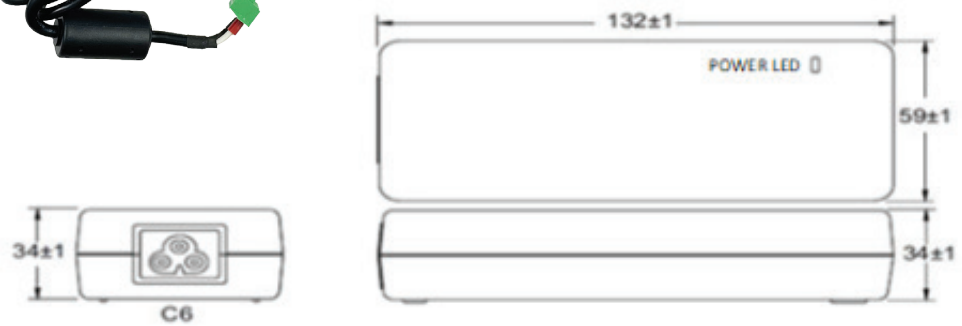

#70-PROGRAMMER - 12 BUTTON

The 12 Button Programmer is used to connect to the controllers to make specific changes in the event that the higher level Alarm Control Unit is not used.



MEMO SHOWCASE SECURITY SYSTEM DIAMOND[E]MOTION SERIES



#70-ALARM CONTROL UNIT

The BOH Control Unit is an optional, additional Back of House Controller. It is only required when remote site access control features are to be utilized; or when additional security from the on-site, BOH is required.

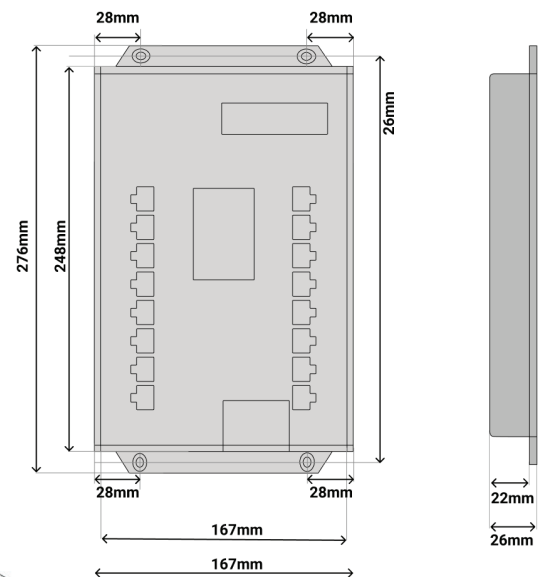

MOUNTING

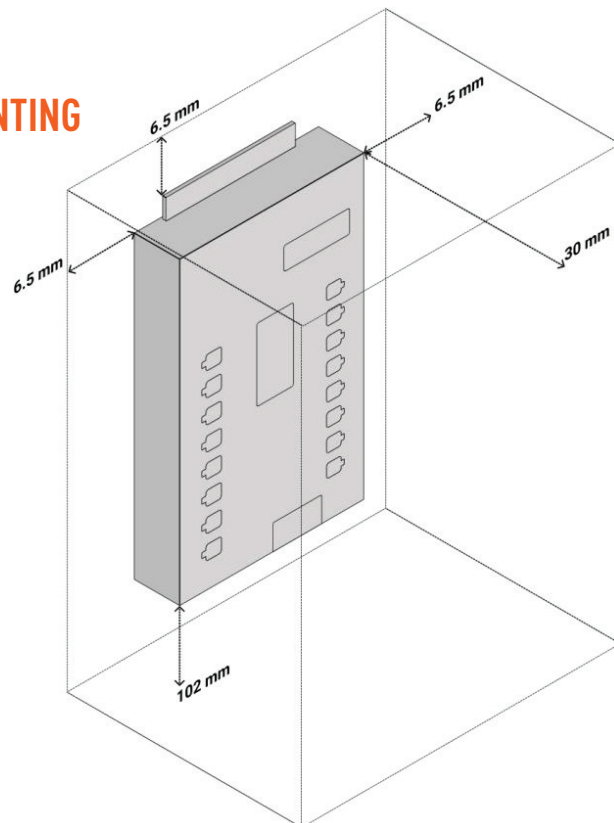

MEMO SHOWCASE SECURITY SYSTEM DIAMOND[E]MOTION SERIES

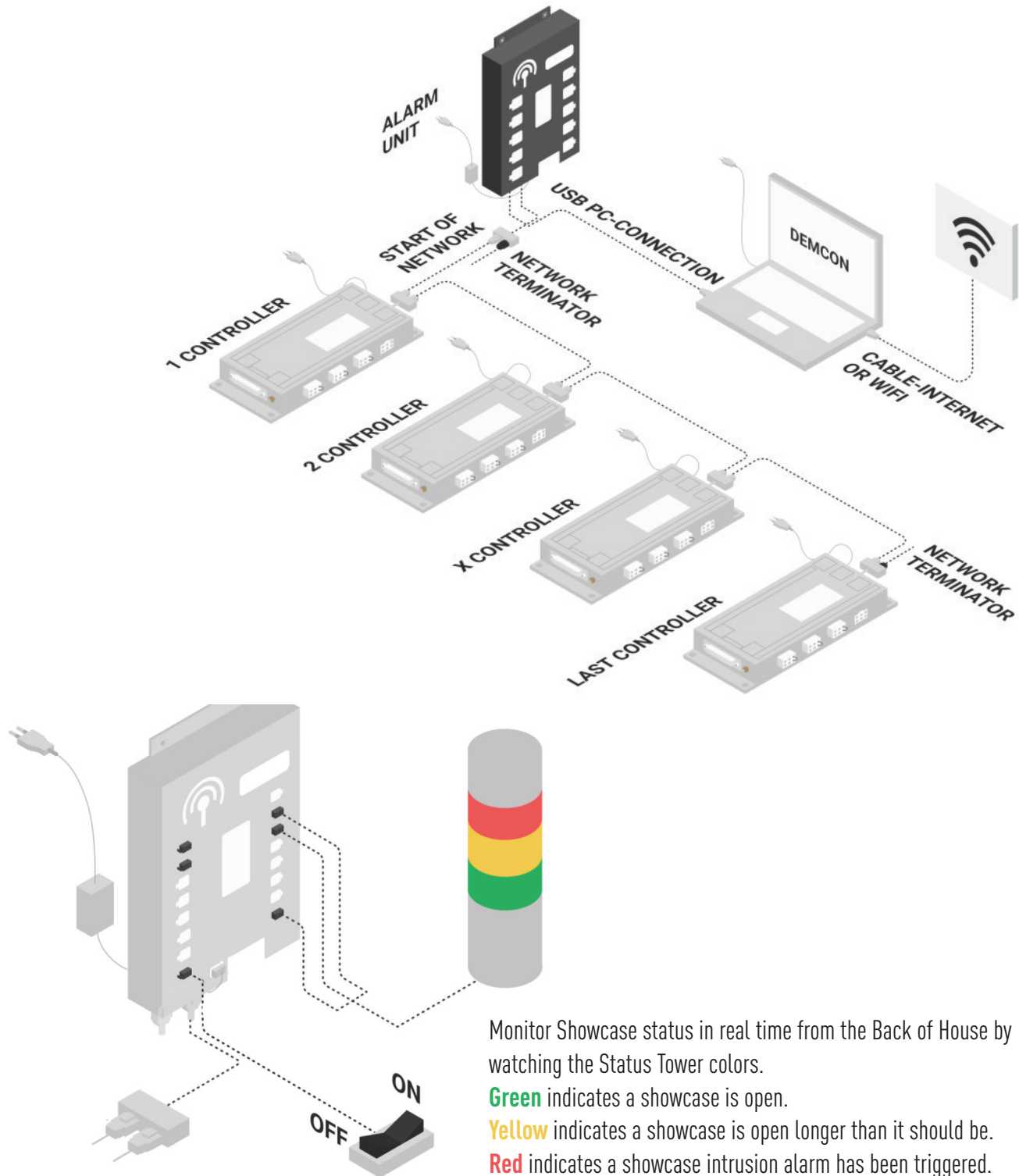

#00-RCI-3510LM CABINET LOCK

The 3510LM cabinet lock features a compact, surface-mounted design for small enclosures. This electric lock has side or top mounting capability for easy installation which makes it suitable for a variety of applications. Positioning of the RCI 3510LM cabinet locking pin determines the lock mode. A simple twist of the pin changes the lock from fail-safe to fail-secure during installation. The built-in monitoring switch indicates whether the mechanism is locked or unlocked for increased monitoring and accountability.



Specifications:

- **ENERGY:** 250mA Field-Selectable 12VAC/VDC, 24VAC/VDC (Max at 12VAC/VDC, 120mA at 24VAC/VDC)
- **STRENGTH:** 250lbf Holding Force
- **WARRANTY:** 3 Year Limited Warranty
- **MODE:** Field-Selectable Fail-Safe & Fail-Secure
- **MONITORING:** Built-in Monitoring Switch

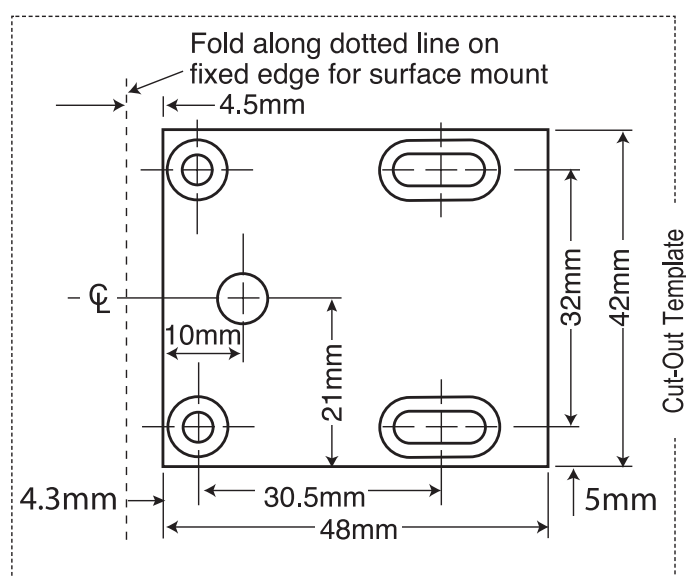

#00-RCI-9320 CONTROLLER / READER



The RCI 9320 Controller / Reader requires a power supply to operate. Please see the Altronix Power supply in this catalog (**Part#00-SMP5CTX-Power Supply**). Note, if the enclosure for the Power Supply is too large, please contact us for a work-around.

#00-RCI-1932-10KP

This “Easy Read-Prox” PROGRAMMING KIT comes with everything you need to set up and use the RCI 9320 Series Access Control product.

The Kit (Book) Contains:

10) User Fobs with (10) User Fob Deletion Cards.

(1) Enrollment Card

(3) Special Function Cards:

- Door Open Time
- Power Fail-Open Release –
For Use with Electric Mags
- Silent Operation



CONCEALED CARD ACCESS ELECTRONIC LOCKING SYSTEM

BOA BPS ELECTRONIC LOCK

BOA's BPS Card Access Locks are a great way to remove the lock from the face of your millwork and hide it beneath the material surface. This is a cost-effective product line that can be powered via a plug-in transformer or with batteries. It is a great alternative to a full-blown card access system and mechanical, key-driven locks. Lost cards are easily deleted and replaced using a Program Card. No computer connection is necessary.

System Features:

- Based on the internal chip system, you can program the lock very easily without a computer or software, just by using a programming card.
- Card range through 3/4" wood or glass. (Reader function is hindered by metallic materials. Call for details).
- Based on a prox system, up to 50 key cards can be activated for each lock.
- Up to 30,000 openings on battery power (Power transformer option also available).
- Simple "invisible" installation. Glass mounting available with optional mounting kit.

Technical Specifications:

- Maximum counter pressure: 5.5 lb (2.5 kg)
- Temperature range: 36-104°F (2-40°C)



#18-DIGITAL KP LOCK

OR



#18-CRD-OP-SET



#18-BPS-LOCK



#18-AC-FRNT-LTCH



#18-AC-PSH-HVYDTY-LTCH

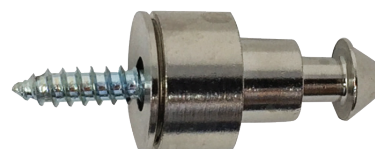

#18-AC-MINI-LTCH

CONCEALED CARD ACCESS ELECTRONIC LOCKS



#18-BPS-LOCK

Plastic Housing version has a built-in Card Reader (not Antenna).
However, External Readers will work with the unit as well.

Metal Housing Version The #18-BPS-Lock - M1 requires an External Reader.

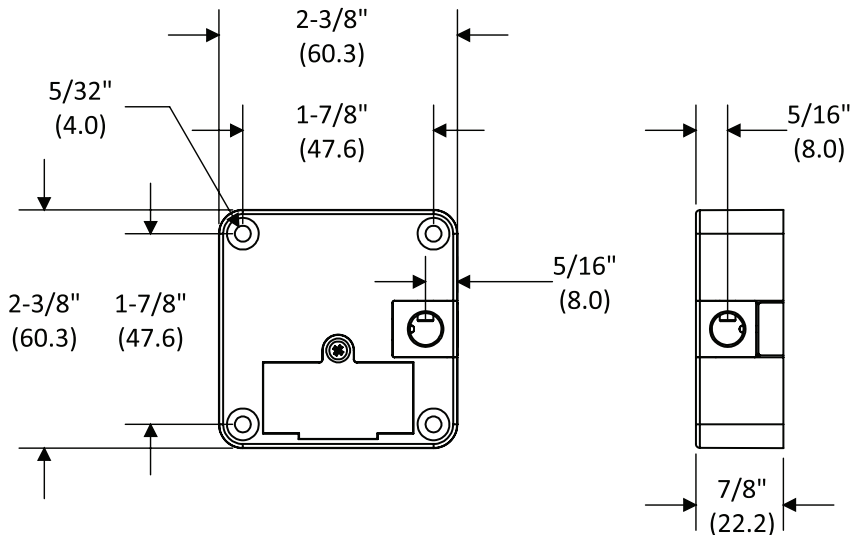

18-BPS-LOCK-MINI

Must be used in conjunction with either of our BPS Locks.

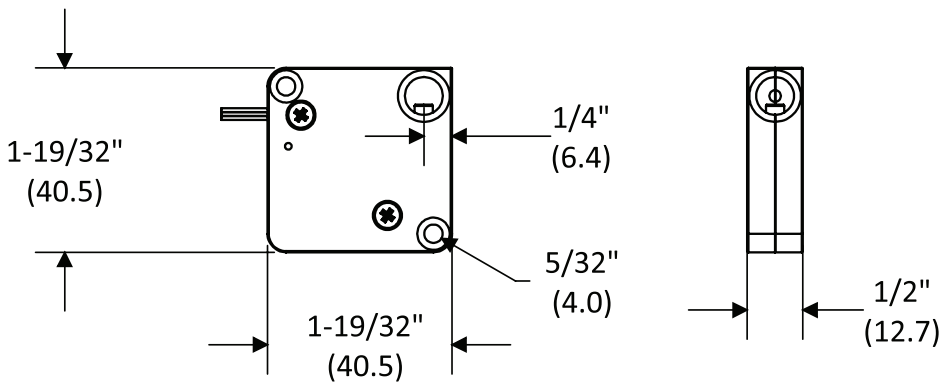
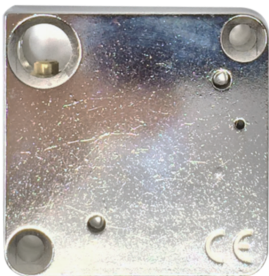

* Parenthesis dimensions are in mm.

CONCEALED CARD ACCESS ELECTRONIC LOCKS

BOA BPS ELECTRONIC LOCK

#18-BPS-RATCHET LOCK

BPS Ratchet electronic sliding door lock
Based on RFID technology



#18-AC-LATCH



#18-AC-MINI-LTCH

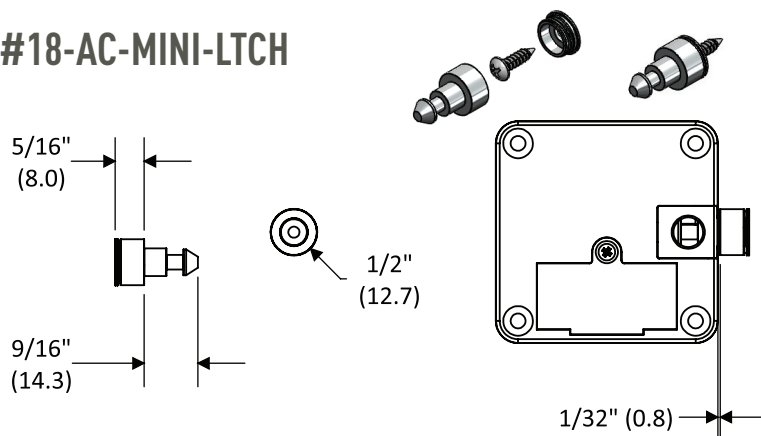

#18-AC-PSH-HVYDTY-LTCH

Stainless steel pin with ~440 lbs (200 kg) breaking point.
Intergrated push pin automatically opens light doors/drawers.

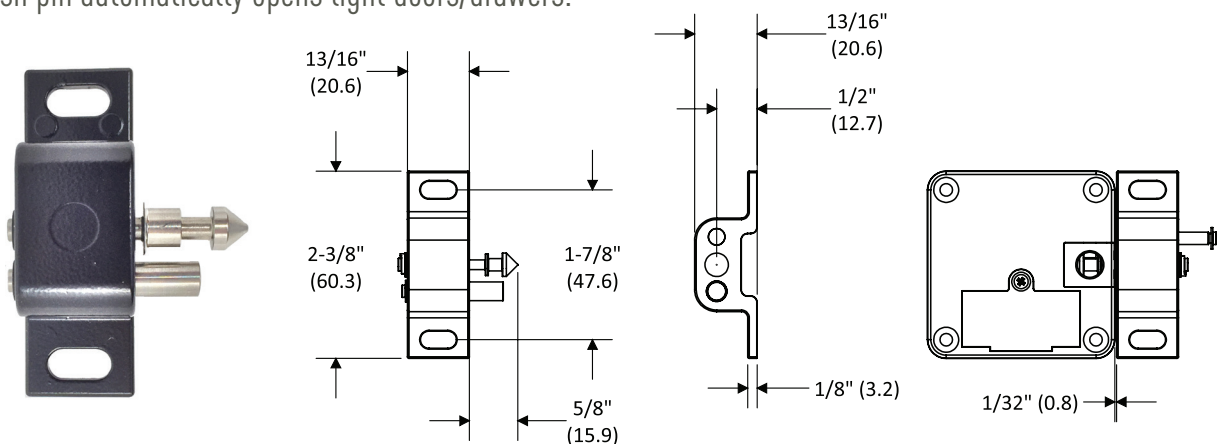

* Parenthesis dimensions are in mm.

CONCEALED CARD ACCESS ELECTRONIC LOCKS/LATCH OPTIONS

BOA BPS ELECTRONIC LOCK

#18-AC-FRNT-LTCH

Locking pin with ~77 lbs (35 kg) breaking point. The flexible pin allows a tolerance of +/- .12" (3 mm).

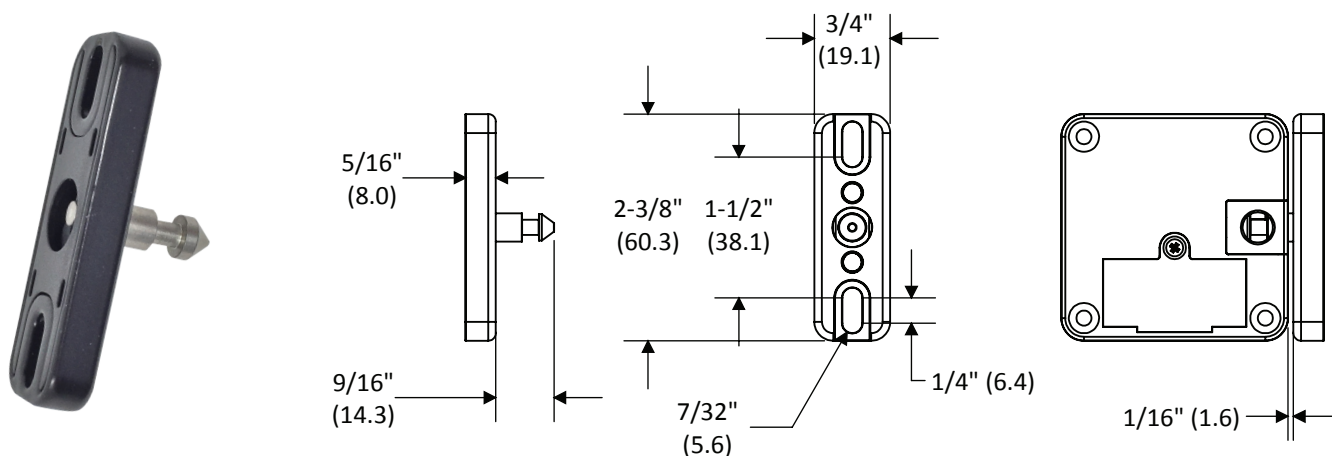

#18-AC-3D-ADJ-LTCH

Allows for up to .24" (6 mm) of adjustment in 3-dimensions for ease of installation. Integrated spring is used as a door pusher for lightweight doors/drawers.

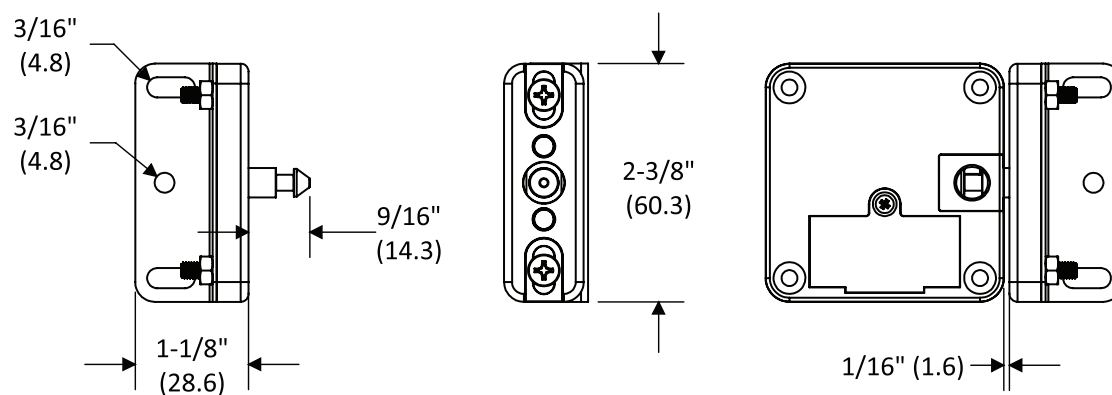

* Parenthesis dimensions are in mm.

CONCEALED CARD ACCESS ELECTRONIC LOCKING SYSTEM

BOA BPS ELECTRONIC LOCK

#18-DIGITAL KP

BPS Keypad uses a 4-digit code to access the lock.



OPTION A: FOR PUBLIC USE

This version is for use in public institutions such as on Lockers. The lock is open in idle mode. The user puts his/her clothes in an open compartment/locker and locks it by entering his/her individual code. The lock is now locked and can only be opened using the previously entered code. As soon as the lock has been opened, the code is deleted and the compartment/locker can be re-used.

Emergency opening for the public lock function can be done via using the Master Code set up when the lock is first installed. A caretaker, for example, can open a locker using this code. An emergency opening will cause the previously entered code to be deleted.

OPTION B: FOR PRIVATE USE

After installing the battery, a personal code can be entered. The LED lights up briefly and the code is entered once again and then confirmed. The lock is locked in idle mode. After entering the correct code, the lock opens for 3 seconds and then closes again automatically.

#18-CRD-OP-SET

Access Cards come in a set of two identical cards. One is kept in the store safe and can be used to delete its twin in the event the twin is lost or stolen.



#18-CRD-WRISTBND -BLK

Operating key fob attached to a wristband with a maximum range of 20mm (.79").



#18-CRD-FOB

Operating key fob with a maximum range of 20mm (.79"). 30mm (1.18") diameter.



CONCEALED CARD ACCESS CARD PROGRAMMING OPTIONS

BOA BPS ELECTRONIC LOCK

PART #	DESCRIPTION
18-CRD-OP	Standard operating card (single card).
18-CRD-OP-SET-P	Standard operating card set. Comes in a shadow pair the second card is meant to be kept in case a lost or stolen key needs to be removed from the programming.
18-CRD-OP-XR	Long range operating card (single card)
18-PRG-CRD	Programming card used to initialize lock units and to authorize user and option cards.
18-OPT-CRD-GYM	Free address - User can decide which lock to gain access to. The lock will remain open and any card will lock it. When the lock is opened, the lock will reset to accept any key for locking.
18-OPT-CRD-7SEC-DLY	Change the delay of the lock before it re-engages automatically from 3 seconds (default) to 7 seconds.
18-OPT-CRD-SOUND	Deactivates all sounds made by the locking unit.
18-OPT-CRD-PROPDELAY	Activate the internal alarm when the door is propped open for over 25 seconds. The alarm deactivates by presenting the card credential or closing the cabinet.
18-OPT-CRD-BOLT	Deactivates the automatic locking function. Bolt option when activated will leave the unit in the open position until the credential is presented to lock.



NOTE: Option cards come in pairs to activate or deactivate the option.

CONCEALED CARD ACCESS ACCESSORIES

BOA BPS ELECTRONIC LOCK

#18-CARD READER

External card reader connects directly to unit (18-LOCK).

Wire Length 5' (1.5 m)

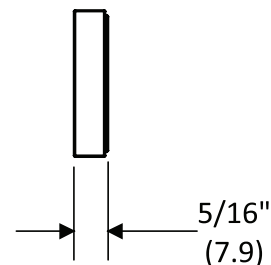
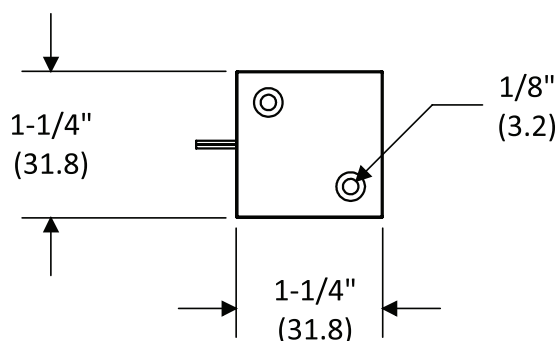

18-AC-SPACER-PLT

Spacer plate prevents wires from being crushed against the mounting surface.

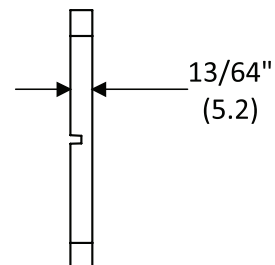
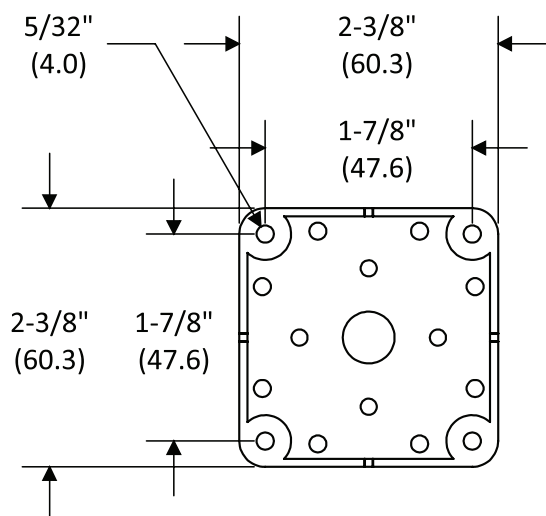
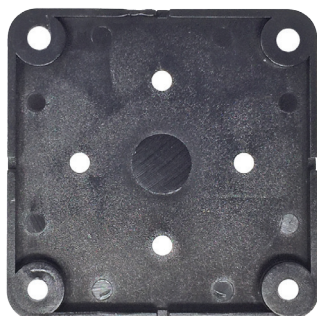

* Parenthesis dimensions are in mm.

CONCEALED CARD ACCESS ELECTRONIC LOCKING SYSTEM

BOA BPS ELECTRONIC LOCK

#18-GLASS LOCK MOUNT KIT

Mount BPS Lock unit to glass with the glass mount kit.

Mounting plate will add ~13/64" (5.2 mm).

Mounting tape has holding force up to 55 lbs (25 kg) or 99 lbs (45 kg) depending on the direction of pull.

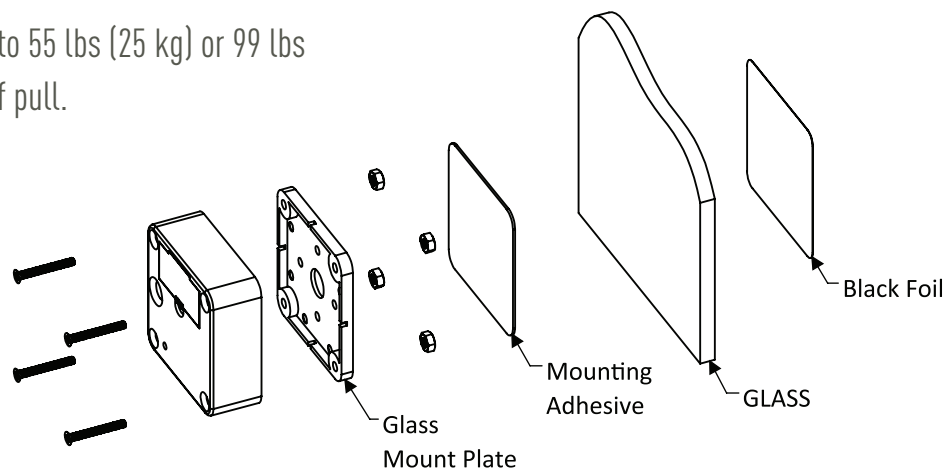

#18-GLASS LATCH MOUNT KIT

Set includes mounting plate, double-sided adhesive tape, black foil, and 4 screws.

For use with:

18-AC-3D-ADJ-LTCH

18-AC-PSH-HVYDTY-LTCH

18-AC-FRNT-LTCH

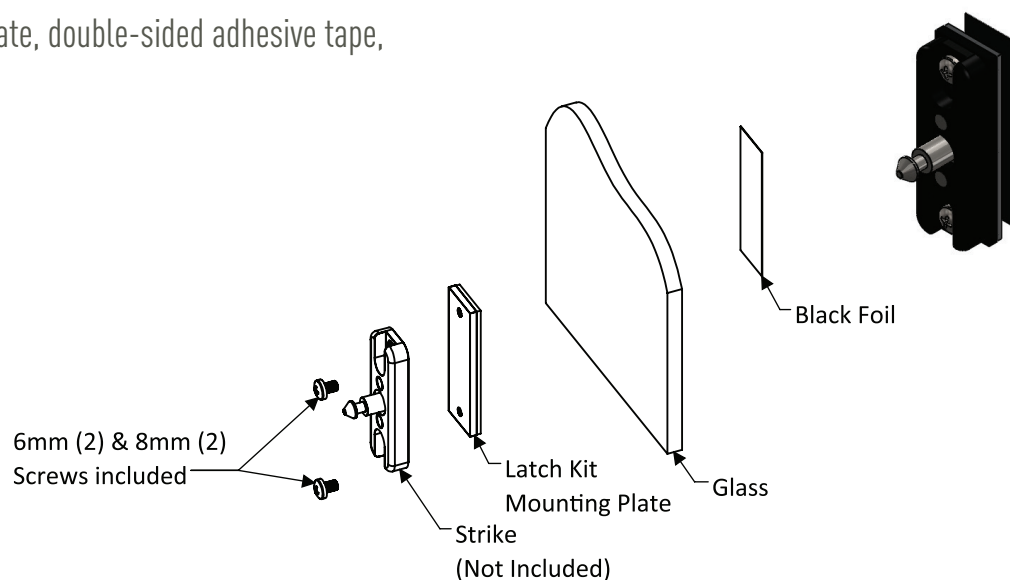

* Parenthesis dimensions are in mm.

ELECTRONIC LOCKING SYSTEM ACCESSORIES

BOA BPS ELECTRONIC LOCK

#18-TRN

Eliminate the need for battery power or use in conjunction with the battery.

Wire Length ~60" (14.5 m).

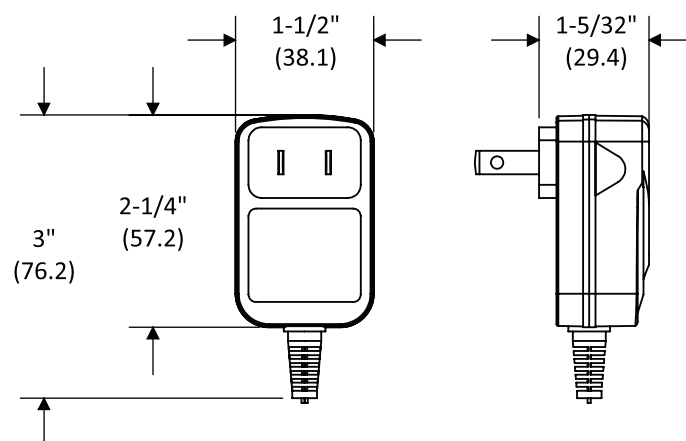

* Parenthesis dimensions are in mm.

#18-BATT

Battery for BPS Electronic Lock



#18-BPS-HUB9

Connects multiple locks together for a plug-n-play splice point.

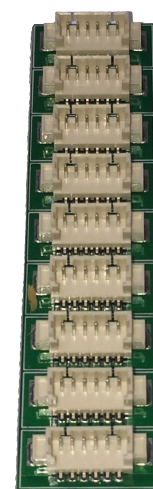

#18-EXT-CABLE-5 (5' / 1.5 M)

#18-EXT-CABLE-8 (8.2' / 2.5 M)

Extension Cables are used to connect BPS units together.



ELECTRONIC LOCKING SYSTEM PROGRAMMING INSTRUCTIONS

BOA BPS ELECTRONIC LOCK

PROGRAMMING INSTRUCTIONS FOR RF CARD:

The User Card and the Shadow Card are identical. The Shadow Card should be kept in the store safe.

If the User Card is lost, you can use the Shadow Card to delete the lost User Card from the locks.

ACTIVATING THE PROGRAMMING CARD

Initializing/activating a programming card

1. Press the push-button on the rear side
2. The lock will make a ticking sound (signal). Hold the programming card on the lock within 3 seconds of hearing this signal.
3. Two short ascending tones will confirm that the programming card has been saved successfully.

INITIALIZING A KEY

Initializing the key card or chip key

1. Please place the programming card onto the lock.
2. The lock will make a ticking sound (signal). Place the key card or chip key onto the lock within 3 seconds of hearing this signal.
3. Two short ascending tones will confirm that initialization was successful.
4. The lock can now be opened using the key card or the chip key.

DELETING THE KEY CARD OR CHIP KEY

1. Please place the programming card onto the lock.
2. The lock will make a ticking sound (signal). Place key card or chip key onto the lock within 3 seconds of hearing this signal.
3. Two short ascending tones will confirm that deletion was successful.

DELETE ALL KEYS

To delete all keys at once, place the programming card onto the lock for several seconds.

ELECTRONIC LOCKING SYSTEM OPERATING INSTRUCTIONS

BOA BPS ELECTRONIC LOCK

OPERATING INSTRUCTIONS FOR DIGITAL LOCK:

LOCK

Choose any open locker, close the door and insert your 4-digit code and press ✓.
The lock will close and the door will be locked.

OPEN

Enter the same code again, press ✓ and the lock will open.

MASTER CODE: (000000)

For a new lock press Press ✓ **Red** LED lights then enter 000000 to open a lock
when the passcode has been forgotten. Use ✓ and the users 6 digit code for an installed lock

CHANGE THE MASTER CODES: (FOR EXAMPLE FROM 000000 TO 123456)

✓✓ 000000 ✓✓ 123456 ✓✓ 123456

Two **green** LED signals will confirm the successful change of the code

RED LED LIGHTS

In case of a **red** LED flash while setting the code, one digit has been pressed twice. After the red flash,
the 4 digit code can be reset.

WRONG ATTEMPTS

After three failed attempts the lock will go into a standby mode for 60 seconds.

BATTERY ALERT

The keypad checks the battery power during the opening process. In case of a low battery the lock will stay open and
the **red** LED lights for 60 seconds. After replacing the battery, the last code is still active.

SCREWS

The attached screws are designed for 19mm (.75 in.) wood panels. For any other thickness, please calculate the
length of the screw with: **THICKNESS OF THE PANEL + 24MM (0.95 IN.)**

ELECTRONIC LOCKING SYSTEM MOUNTING INSTRUCTIONS

BOA BPS ELECTRONIC LOCK

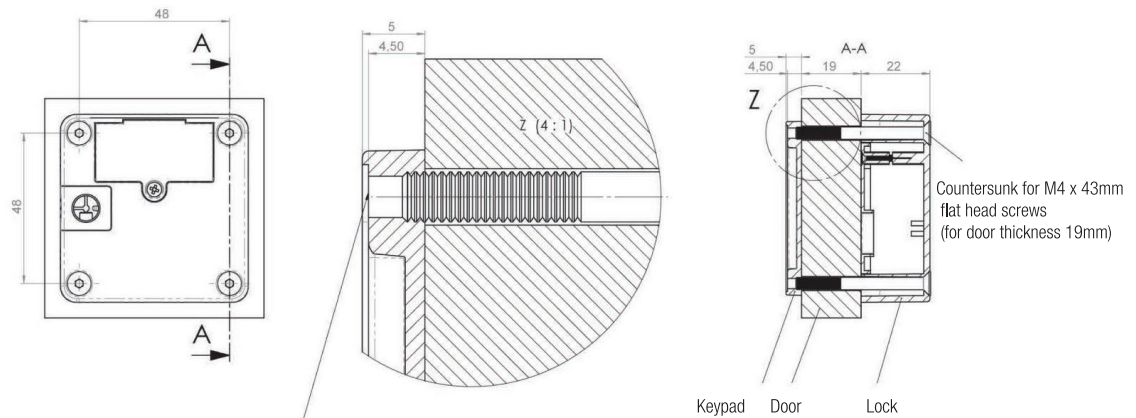
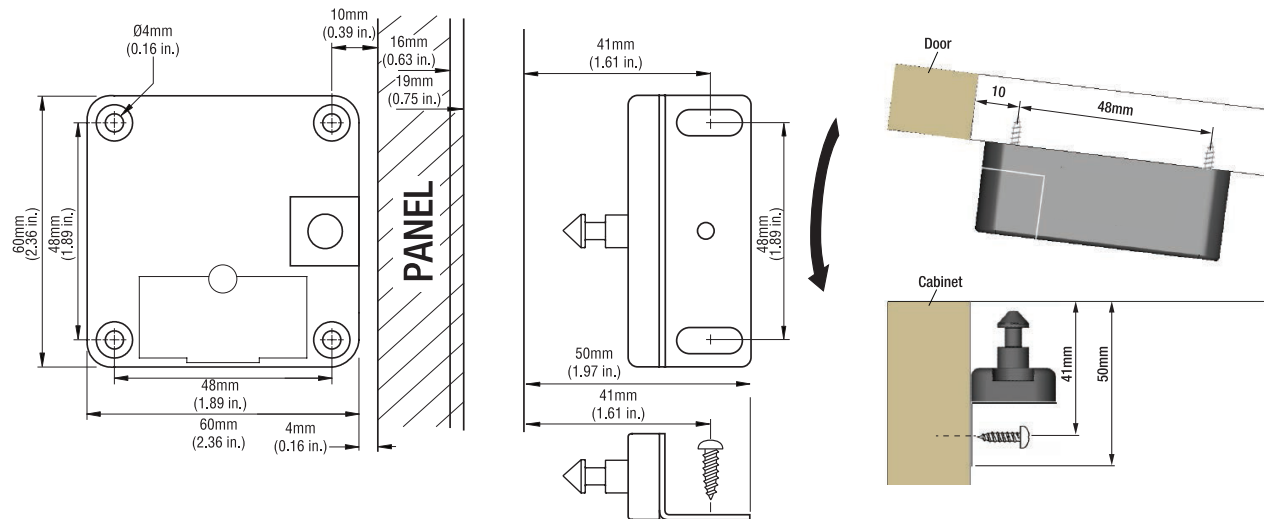

Warning: note screw length:
Screw should not protrude beyond this edge

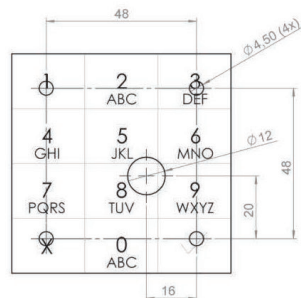

Hole pattern
on door

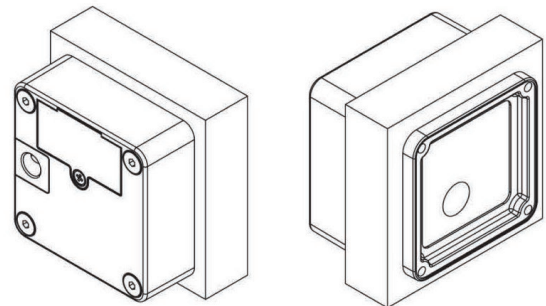

CABINET & LOCKER ELECTRONIC LOCKING SYSTEM

BOA BPS ELECTRONIC LOCK

#50-CL-AA-DIGITAL

KP 20 battery powered, low cost cabinet lock for low to medium security applications with 75 lbs of holding force.



Features:

- Stand-alone access control
- No audit trail
- 12 button keypad
- LEDs indicate valid/invalid access
- Supports 1 (4 to 12 digit) master code
- Supports 1 (4 to 12 digit) user code
- Aluminum die-cast construction
- Non-handed
- Installs on wood or metal cabinet drawers or doors 1 to 23 mm thick

Specifications:

- FCC Part 15 compliant
- IC compliant
- External emergency power through micro USB
- Holding Force: Static strength 75 lbs
- Temperature: 32 to 122F [0 to 50C]
- Humidity: 0 to 90% RH

Electrical:

- 30,000 cycles
- (3) "AAA" alkaline batteries (not included)

#50-CL-AA-RF

K20 cabinet lock



Features:

- Stand-alone access control
- No audit trail
- 13.56 MHz RFID card technology
- LEDs indicate valid/invalid access
- Supports 1 to 20 master credentials
- Supports 1 to 20 user credentials
- Aluminum die-cast construction
- Non-handed
- Installs on wood or metal cabinet drawers or doors 1 to 23 mm thick

Specifications:

- FCC Part 15 compliant
- IC compliant
- Holding Force: Static strength 75 lbs
- Temperature: 32 to 122F [0 to 50C]
- Humidity: 0 to 90% RH
- Card Technology: MIFARE Classic™, MIFARE Ultralight™

Electrical:

- 30,000 cycles
- (3) "AAA" alkaline batteries (not included)
- External emergency power through micro USB

CABINET & LOCKER ELECTRONIC LOCKING SYSTEM

BOA BPS ELECTRONIC LOCK

#50-CL-REGULATOR

Available in two versions: self-locking and manual locking.



Applications:

- Cabinet doors or drawers
- Lockers
- Storage enclosures
- File cabinets
- Computer server racks
- Twenty codes per lock: nineteen user codes and one supervisor code; code length is 4-8 digits

Features:

- Low battery indicator
- 75,000 cycles; extended battery life reduces replacement and labor/maintenance costs
- Battery compartment is easily accessible from the outside of the cabinet
- Four different keypad configurations: left hand, right hand, vertical bottom and vertical top (available in both self-locking and manual locking)
- Install on new or retrofit applications
- Uses 3/4" mounting hole

NOTE: location of door hinges determines hand of door when facing door, i.e. if hinges are on the right, order right hand mount.

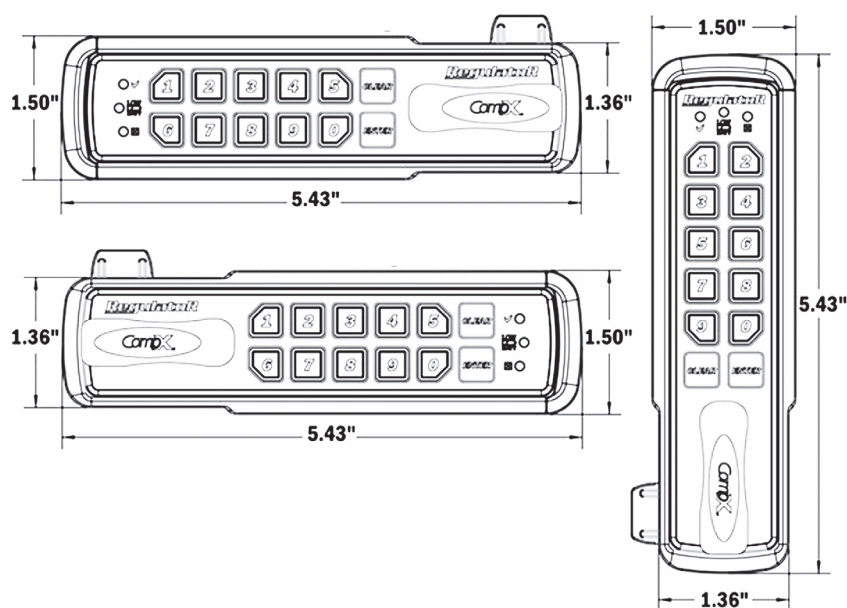

CABINET & LOCKER ELECTRONIC LOCKING SYSTEM

BOA BPS ELECTRONIC LOCK

SELF-LOCKING features SlamCAM, a spring loaded latch, which allows the user simply to close the cabinet door or drawer — no need to return the knob to the locked position.

MANUAL LOCKING version, which uses existing CompX National cams, requires users to rotate the knob into the unlocked and locked positions.

Self-locking:

- Self-locking, featuring SlamCAM
- Spacers provide additional latching dimensions
- 75,000 cycles – 2 AAA batteries included
- Convenient external battery installation/removal
- Low battery indicator
- Three Barrel lengths – 7/16", 1-3/16", 1-3/4"
- Easy to clean membrane keypad
- 19 user codes and 1 supervisor code
- Installs on wood or metal cabinet doors and drawers

Manual locking:

- 75,000 cycles – 2 AAA batteries included
- Convenient external battery installation/removal
- Low battery indicator
- Three barrel lengths – 7/16", 1-3/16", 1-3/4"
- Single use mode
- Easy to clean membrane keypad
- 19 user codes and 1 supervisor code
- Installs on wood or metal cabinet doors and drawers

BACK OF HOUSE ELECTRONIC LOCKING SYSTEM

BOA BPS ELECTRONIC LOCK

#50-TRILOGY-SERIES-IC-26D

Electronic Entrance Locks



Trilogy series electronic entrance locks are available with Keypad or RF Card Access and with SFIC Key Access as a back-up.

Trilogy models are available in WP weatherproof and non-WP standard models for interior doors, as well as panic bar access. Please contact us for more info.

Features:

- Grade 1 Durability. Dependable lockset with rugged clutch mechanism, plus vandal-proof all metal keypad.
- Multi-level user codes: Master, 10 managers, 90 users, 3 service codes
- Up to 100 different user codes (3-6 digits)
- 100% keypad programmable with a fingertip
- Individual, group or total user lockout codes
- Easy passage mode by manager and/or master
- Easy to install in about an hour, retrofits cylindrical Knob sets and digital lock using slightly modified ANSI 161 Series Prep
- Standalone battery operated; 5 AA batteries rated at 200,000 cycles
- Non-handed for easy installation and versatility
- 2-wire remote override
- Visual and audible entry indicators
- WP Models for weatherproof performance, water-sealed for use inside and out, with operational temperature range of +151°F to -31°F (+66°C to -35°C)

ELECTRONIC LOCKING SYSTEM

NEXGEN XT



Nexgen XT is a pure electronic master key system providing Controlled Access, Accountability, Physical Security and effective System Management. Nexgen XT offers the benefits of electronic access control in a key operated lock. Keys are programmed to operate designated locks during a set schedule. Nexgen XT locks and keys record every access and attempted access for full visibility to who, where, and when.

Features:

- **MEMORY:** Non-volatile Memory Storing 2000 Audit Events
- **SOFTWARE:** Local software client or web hosted option available
- **POWER:** Power supplied by the key, no hard wiring required

Lock / Cylinder:

- No wiring required—all power provided by the key
- Indoor / outdoor use—stainless steel shell construction
- 2000 audit events
- Unauthorized key list
- Variety of retrofit cylinder formats

Key:

- Small, robust electronic key with stainless steel housing
- All programming done at the key
- Key holds operating and expiration schedule
- Rechargeable battery, 1,500-1,800 openings per charge (when cylinder unlock time is set to .8 seconds)
- Access: 5,000 cylinders maximum
- Audit: 5,000 events maximum
- Heavy duty stainless steel construction
- Stand-alone, network, WEB and mobile programming options



NEXGEN XT CAM LOCKS



05 CL X XX(X) XX

All CAMs are sold as a set of 2. CAMs containing both Vertical and Horizontal Tenons.

Nexgen XT series is Key Retaining Only. The lock must be locked in order to remove the key.

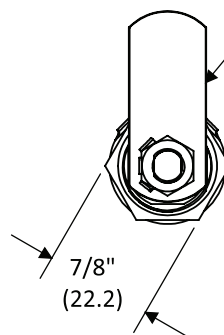
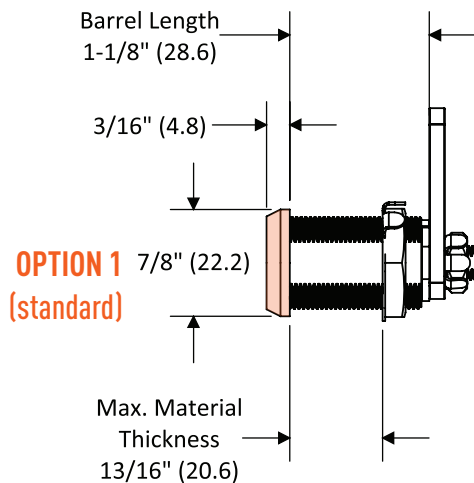

Note when selecting a CAM the threaded tail on this lock has a vertical tenon. Using "V" designation CAM's will allow for the locked at 12 o'clock orientation shown.

* Parenthesis dimensions are in mm.

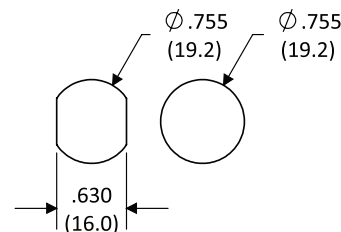
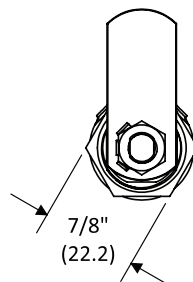
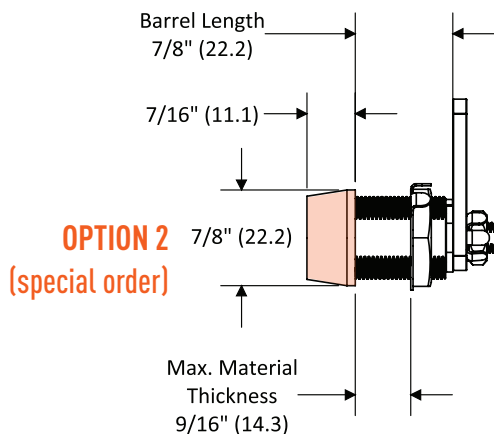

NOTE: If installing into a round hole use a Double-D mounting plate to keep the lock from spinning!

05 CL X XX(X) XX

X = BARREL LENGTH

2 = 7/8" (22.2mm)

3 = 1-1/8" (28.6mm)

XX(X) = CAM ROTATION

90 = 90° Right

180 = 180° Right

(Call for info on Left-hand rotation)

XX = METAL FINISH

SS = Satin Stainless (Standard)

PN = Polished Nickel

SC = Satin Chrome

CF = Custom Finish

NEXGEN XT CAM LOCKS



STRAIGHT FLAT CAM

Custom sizes available.

PART #	CAM LENGTH
#00-CAM-0750	0.750" (19.1mm)
#00-CAM-1250	1.250" (31.8mm)
#00-CAM-1750	1.750" (44.5mm)
#00-CAM-2000	2.000" (50.8mm)

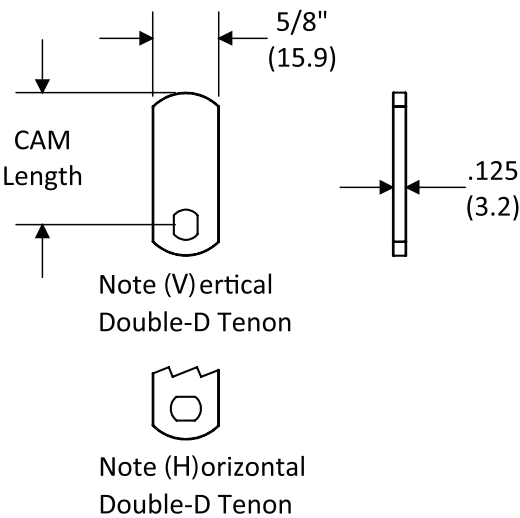

OFFSET CAM

Custom sizes available.

PART #	CAM LENGTH	OFFSET
00-CAM-1250 x 0313	1.250" (31.8mm)	0.3125" (7.9mm)
00-CAM-2000 x 0313	2.000" (50.8mm)	0.3125" (7.9mm)

** Parenthesis dimensions are in mm.*

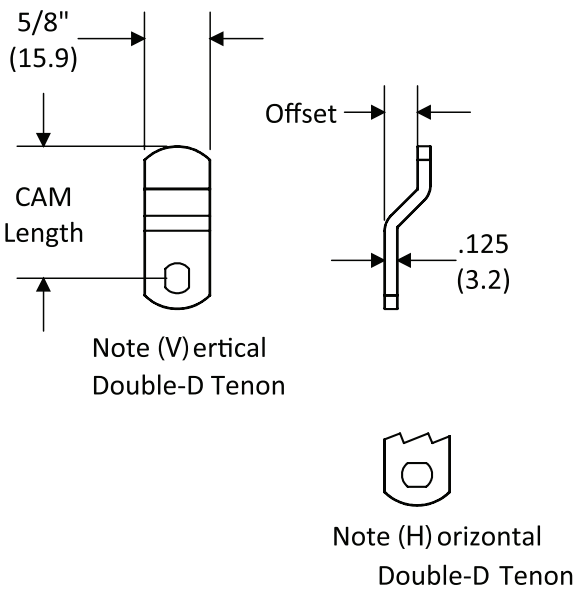

NEXGEN XT DRAWER LOCKS



05 BD L **XX(X)** **XX** DEAD BOLT DRAWER LOCK

Nominal Bolt travel is 7/16" (11.1 mm)

Short bolt (BS) option retracts completely into housing

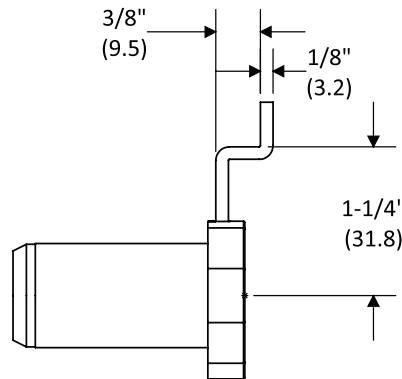
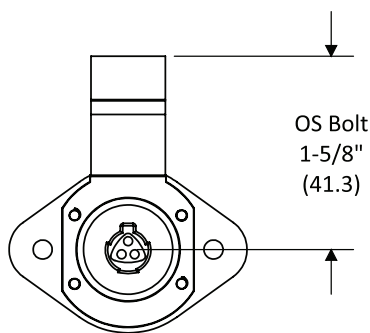
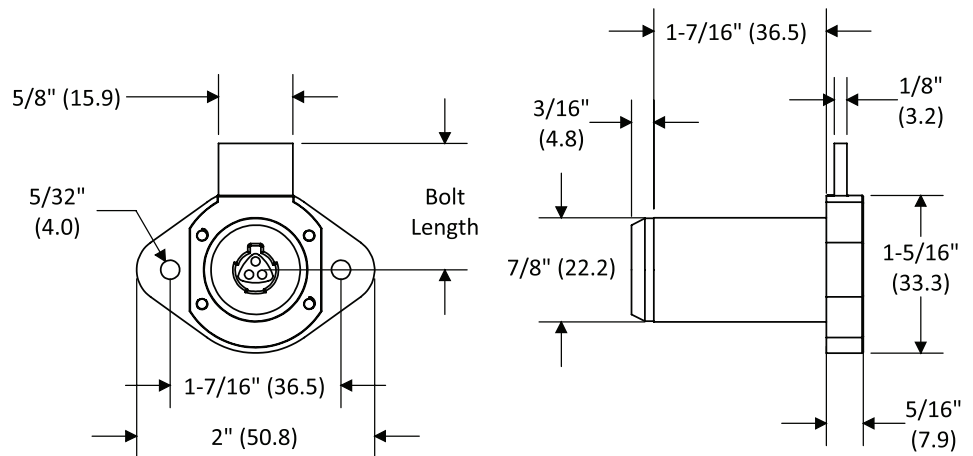

* Parenthesis dimensions are in mm.

05 BD L **XX(X)** **XX**

XX(X) = BOLT TYPE

BS = 1-1/16" (27.0 mm)

BL = 1-11/16" (42.9 mm)

BXL = 3-1/8" (79.4 mm)

OS = 3/8" (9.5 mm) Offset Bolt

XX = METAL FINISH

PN = Polished Nickel (Standard)

SC = Satin Chrome

CF = Custom Finish

NEXGEN XT DRAWER LOCK



05 BDL **XX(X)** **XX**

"PIT BULL" DRAWER LOCK

Nominal Bolt travel is 7/16" (11.1 mm)

Short bolt (BS & BSB) options retract completely into housing.

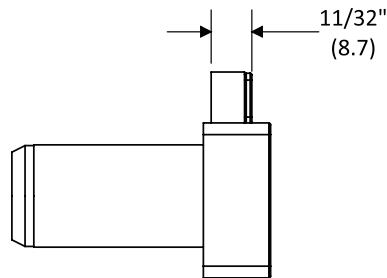
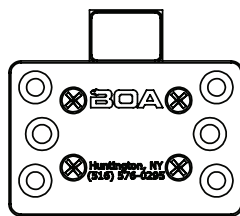

Rubber Bumper Bolts BSB/BLB

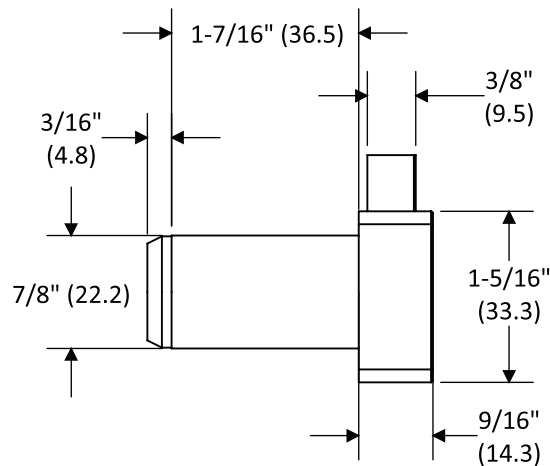
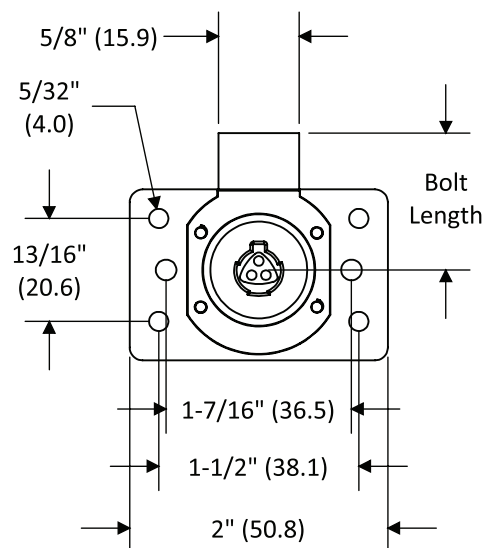

Standard Bolts BS/BL

* Parenthesis dimensions are in mm.

05 BDL **XX(X)** **XX**

XX(X) = BOLT TYPE

BS = 1-1/16" (27.0 mm)

BL = 1-11/16" (42.9 mm)

BSB = 1-1/16" (27.0 mm) with Rubber Bumper

XX = METAL FINISH

PN = Polished Nickel (Standard)

SC = Satin Chrome

CF = Custom Finish

NEXGEN XT DRAWER LOCK

medeco®

05 SB L **XX** N **XX** SANP BOLT DRAWER LOCK

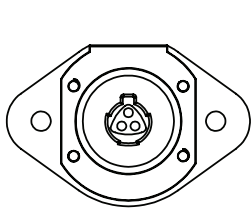

"VI" Orientation

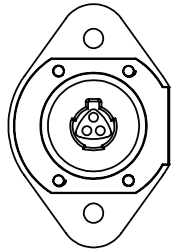

"LR" Orientation

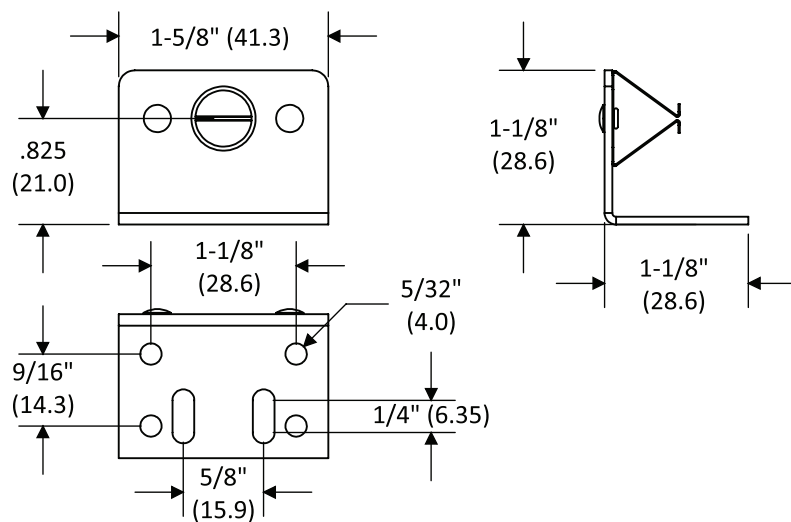
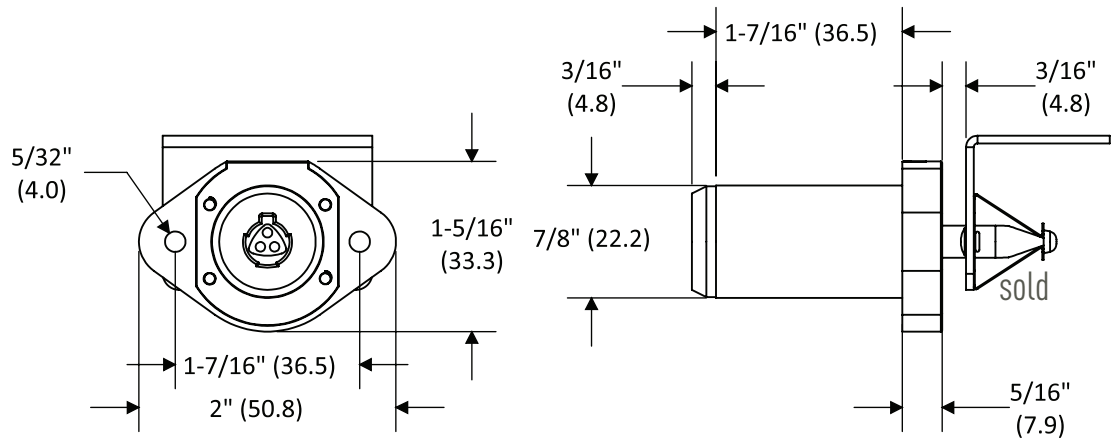

* Parenthesis dimensions are in mm.

05 SB L **XX** N **XX**

XX = ORIENTATION

VI = Vertical or Inverted

LR = Left or Right

XX = METAL FINISH

PN = Polished Nickel (Standard)

SC = Satin Chrome

CF = Custom Finish

NEXGEN XT PLUNGER LOCK

medeco®

05 PL **XX** **XX**
PLUNGER LOCK

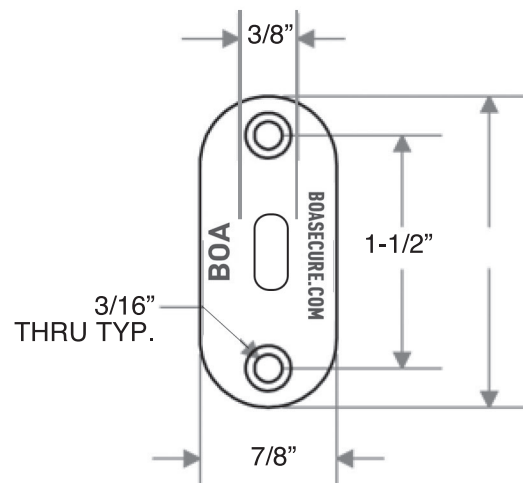
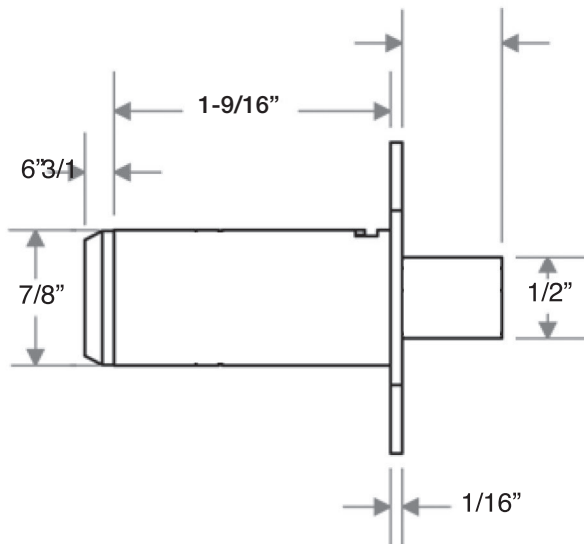
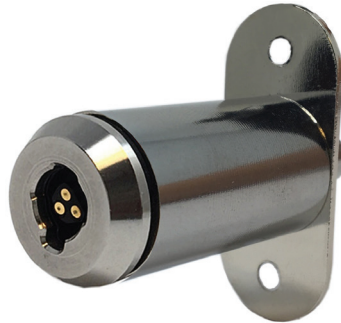

05 PL **XX** **XX**

XX = MATERIAL INSTALLED ON

WD = Wood

MT = Metal

GR = Glass w/Round Hole

XX = METAL FINISH

PN = Polished Nickel (Standard)

SC = Satin Chrome

CF = Custom Finish

NEXGEN XT SFIC CORES



#05-SFIC-CORE

Small Format Interchangeable Core (SFIC)

Convert a BEST Style Lock to a full blown Access Control System in 5 minutes.

- Direct replacement for mechanical SFIC cylinders without any hardware modifications.
- Ideal for loss and liability management
- Upgrade from a mechanical SFIC (Best) Core to an Electronic
- Access Control capabilities without wiring or power supply
- Users can audit keys, program a schedule and track who opens a lock and when, all while eliminating the cost of rekeying mechanical locks.



NEXGEN XT KEYS

medeco®

#05-KEY-OP SLIM

Slim line key

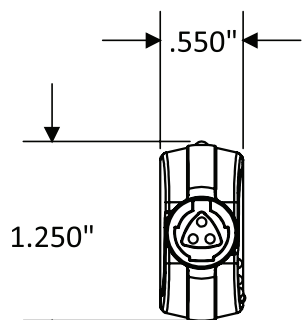

Weight: 1.25 oz

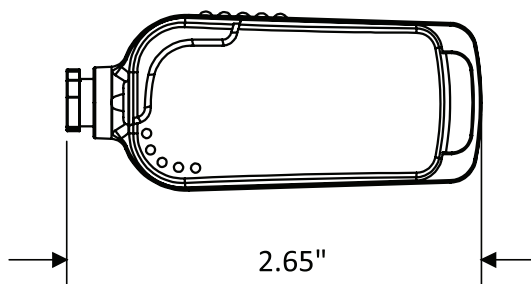

#05-KEY-INDUSTRIAL

Heavy duty key

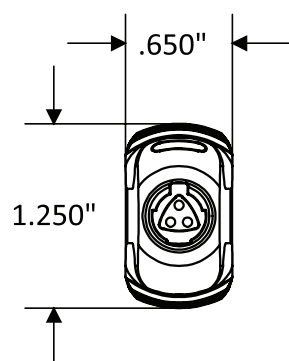

Weight: 2.38 oz

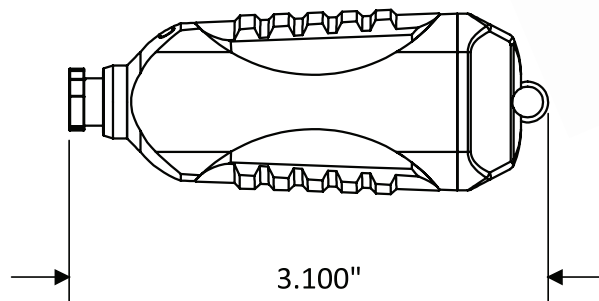

NEXGEN XT ACCESORIES



PART #	DESCRIPTION
05-CHG	Portable Key Charging Adapter only (order cable separately).
05-CHG-SET	Portable Key Charging Adapter (includes 05-USB cable 05-TRN).
05-DOCK-SET	USB System Dongle (includes 05-USB cable).
05-MOBILE-DOCK	Mobile Programmer allows XT Industrial and Slim Line keys to be programmed remotely via Bluetooth (on an Android device) or via a USB tether to a laptop.
05-REMOTE-DOCK	Remote Wall Programmer - Program and update Nexgen XT Keys remotely via an internet connection to the Medeco XT Web Manager.
05-MCHG	Multi Key Charger - Charge up to 10 Nexgen XT keys simultaneously (does not program keys). Includes transformer.
05-TRN	Wall Power Adapter for use with 05-CHG.
05-TRN-V	Vehicle Power Adapter for use with 05-CHG.
05-USB	USB Cable.
05-SOFTWARE-WH	Nexgen XT Web Hosted Software (call for details).
05-SYS-DONGLE-SA	USB Nexgen XT System Dongle (for stand alone systems only).
05-SOFTWARE-SA	Nexgen XT Stand Alone Software (call for details).



ALTRONIX POWER SUPPLY

#00-SMP5CTX-POWER SUPPLY

Power supply/charger converts a 115VAC/230VAC, 50/60Hz input into a regulated 12VDC or 24VDC output @ 4A continuous supply current.

INPUT

- 115VAC, 50/60Hz, 0.95A or 230VAC, 50/60Hz, 0.5A

OUTPUT

- 12VDC or 24VDC selectable output
- 4A supply current
- Filtered and electronically regulated outputs
- Short circuit and thermal overload protection

BATTERY BACKUP

- Built-in charger for sealed lead acid or gel type batteries
- Zero voltage drop when switching over to battery backup

VISUAL INDICATORS

- AC input and DC output LED indicators

TEMPERATURE

- Operating: 0° C to 49° C (32° F to 120° F)
- Storage: - 20° C to 70° C (- 4° F to 158° F)
- Relative Humidity 85% +/- 5%.

BTU/Hr. (approx.):

12VDC: 25 BTU/Hr

24VDC: 49 BTU/Hr

System AC input VA requirement:

115VAC: 109.25VA

230VAC: 115VA



ENCLOSURE:

- Wall mount enclosure for indoor use.
- Accommodates up to two (2) 12VDC/7AH Batteries.
- Dimensions 13"W x 13.5"H x 3.25"D (330 mm W x 343 mm H x 83 mm D)
- 1/2" and 3/4" combination knockouts





BOA SECURITY TECHNOLOGIES

586 New York Avenue, Unit 3

Huntington, NY 11743

T 516-576-0295 | F 631-470-8099

Alan.Lurie@BOA-ST.com

www.BoaSecure.com
