



**SMALL FORMAT  
INTERCHANGEABLE CORE (SFIC) LOCKS**

MARCH 2024

## **BOA SECURITY TECHNOLOGIES, INC.**

Located in Huntington, New York, we originally established our business in 1997 under the name of BOA Handcuff Company, Inc. At that time our business focus was solely our patented High Security Handcuffs for Correctional Facilities worldwide. In 2014 we rebranded our company and began competing for business in the area we all knew best; Retail Cabinet and Showcase Locks. However, we are much more than just a manufacturer, distributor or service provider. We are integrators. We find the best product or mix of products to find solutions for our customers. We take pride in what we do and who we do it for. We do not work on excessive margins as many of our competitors. We work on smaller margins, do a great job and have built our business accordingly. We service some of the best and biggest retailers and correctional facilities in the world and would be proud to add you to our list of happy clients.

### **WHAT:**

Specialized Manufacturer, Distributor and Field Service Provider of Locks used by Retailers for both their showcases as well as interior and perimeter doors.

### **WHY:**

We will save you money and ensure your security via a diversified vendor base with equivalent if not better products and services.

### **WHERE:**

BOA services our clients all through the United States and Canada.

### **WHEN:**

Typical lead times for orders are 7-10 days after receipt of order. Typical response times to “request for service” are within 24 hours. If you require faster service, just tell us so.

Ramp up Time for transferring business to BOA from current vendor is 45 days for BOA to prepare component inventory to meet your immediate needs.

### **HOW:**

Utilizing our extensive inventory of components (either manufactured by us or simply distributed by us), we provide showcase locks and door hardware that meet your specific needs for plug and play replacement or new installations. In addition, our Field Service Tech’s are ready to go at a moment’s notice anywhere throughout the U.S. and Canada. Just send us an email and we will take the issue off your plate.

# GENERAL INFORMATION

## Standard Plating Finish



## Special Plating Finishes

*(Extended lead-time and plating lot charges may apply)*



## Custom Plating Finish

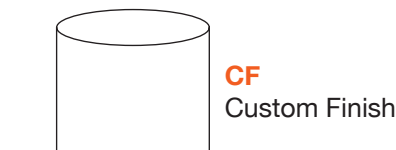

## DELIVERY:

At BOA, we assemble every lock to order and strive to meet your requested in-house date. If we cannot meet your requested date, we will advise you within 24-hours of receiving your order. Our standard lead time is to ship within 10-days after receipt of your order. Rush orders and emergency services are available.

BOA's large component inventory and assemble-to-order factory enables you to order locks keyed alike, keyed differently or master keyed in groups using hundreds of key combinations. All keys are now sold separately.

## PLATING:

Our standard plating finish is either Brushed or Polished Chrome; depending upon the specific product line being ordered. A wide range of special plating finishes are also available; including Satin Nickel, Polished Brass, Satin Brass, Statuary Bronze, Matte Black and Custom Finishes to match your showcase hardware. Please note: Extended lead-time and plating lot charges may apply to Special and Custom finishes. Please call us for details.

## KEY CONTROL:

BOA's standard operating procedure is to request your end-user name and exact location. This enables us to maintain your key plans by store, retail department, showcase/cabinets, or office. We maintain a historical database of keying records. This gives you the ability to match key numbers of previous orders.

## KEY RETAINING VS. NON-KEY RETAINING LOCK FUNCTION:

Standard high security lock operation is Key Retaining (Captive), which means that the operating key can be removed from the lock in the locked position. For lower security situations, Non-Captive key operation is the standard. This means the key is removable in both the locked and unlocked position.

**NOTE: Cores are sold separately from housings.**



Cores are available in keyed alike, keyed different, master keyed, grand master keyed and great grand master keyed configurations. Available in A2 Key systems built and maintained by BOA.

PLATING FINISH: 626/26D Brushed Satin Chrome  
(custom finishes available)

## Unrestricted Keyway Core # 35-CORE-7-SC-X-XX

**X** = Unrestricted BEST® Keyway Options: A, B, C, D, **E**, F, G, H, J, K, L, M, Q, R

**NOTE:** Our Standard Keyway is "**E**". If you need to match a specific keyway, please call to discuss.

**XX** = KA = Keyed Alike    **XX** = KD = Keyed Differently

## Restricted Keyway Core # 55-Core-Peaks-7PJ-SC-XX

## Unrestricted Keyway Keys # 35-KEY-X-OP/CTL/M

## Restricted Keyway Keys # 55-Key-OP/CTL/M - Peaks-7PJ

## CORE INSTALLATION

To correctly insert the Interchangeable Core into the lock housing,

**1** Check if the prongs inside the housing are in the horizontal position. If they are NOT, then **2** insert orange actuator to orient them to the **3** horizontal position. After they are aligned, **4** insert core into housing using the Control Key to lock it in place.



↑ Instruction Video

# CAM LOCKS



SFIC Cam Lock  
Patent No.: U.S. 8,028,555B2

Base Part#: 55CL XXXX X XX XXX XX

\* Parenthesis dimensions are in mm.

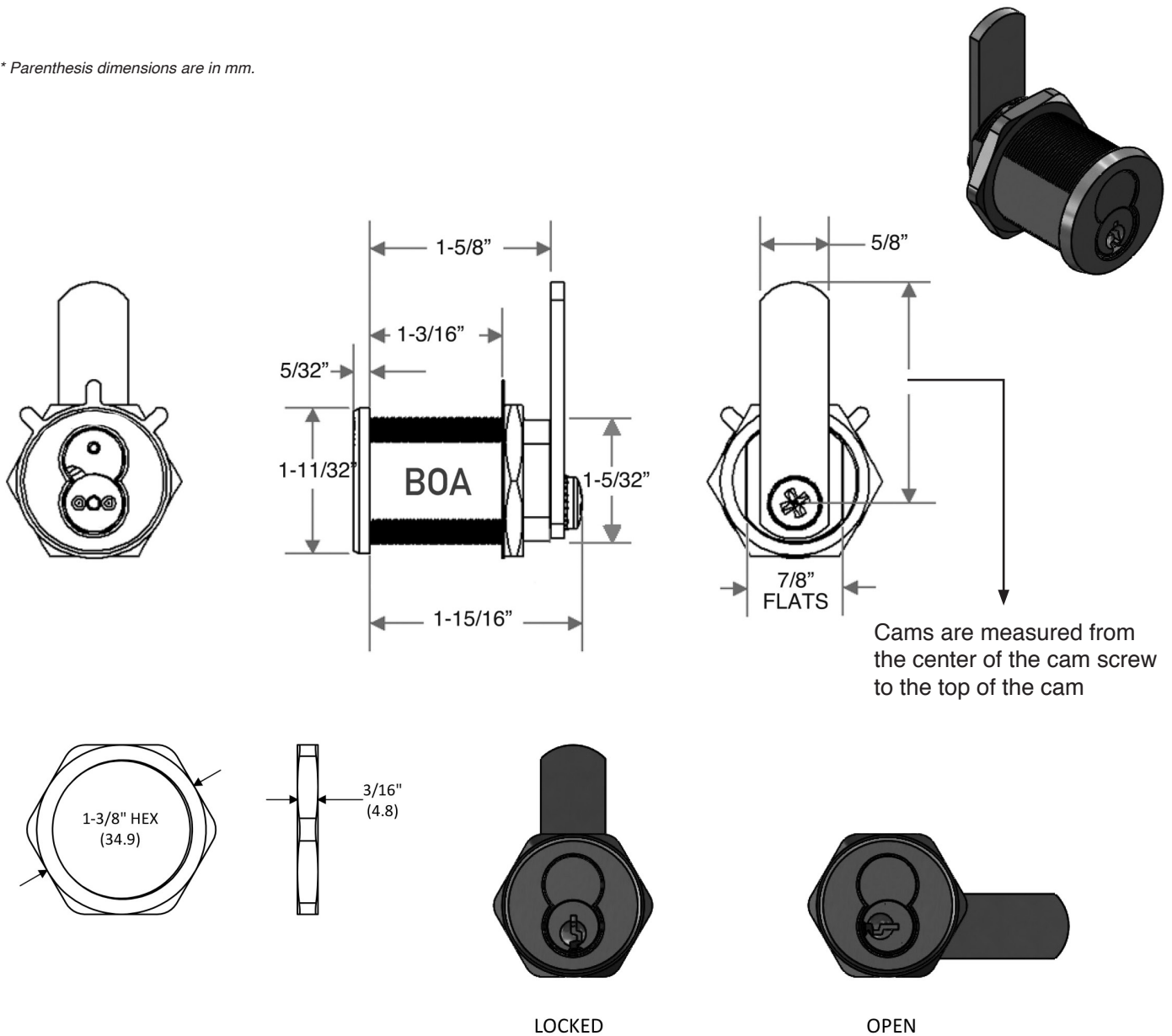

**CORES NOT INCLUDED  
WITH THIS LOCK**

# CAM LOCKS

## STRAIGHT CAM

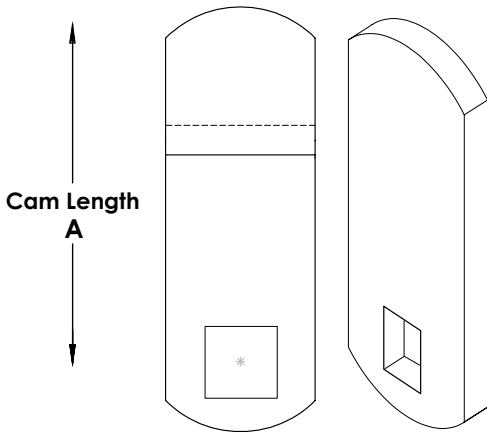

## OFFSET CAM

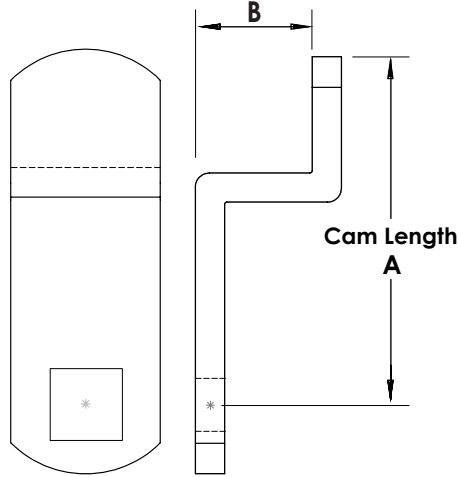

**Note:** All cams are reversible.

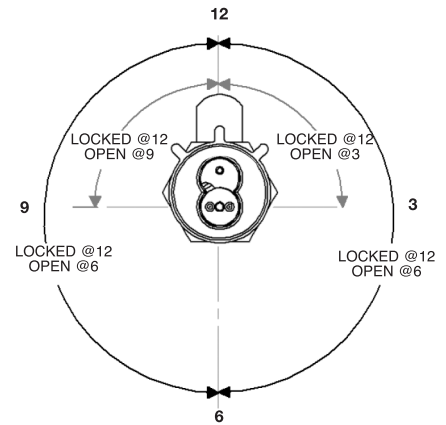

\*All 180 degree rotations are clockwise, unless specified.

## 55CL XXXX X XX XXX XX

### XXXX = ROTATION

	Locked	Open
0312	3	12
0306	3	6
0309	3	9
0612	6	12
0603	6	3
0609	6	9
0912	9	12
0903	9	3
0906	9	6
1203	12	3
1206	12	6
1209	12	9

### X = KEY FUNCTION

- 1 = Captive
- 2 = Non Captive
- XX = METAL FINISH**
- BC = Brushed Chrome (Standard)
- PC = Polished Chrome
- PB = Polished Brass
- SB = Satin Brass
- BL = Matte Black
- CF = Custom Finish

### XXX = CAM TYPE

#### Straight

- 625 = 0.0625
- 750 = 0.7500
- 875 = 0.8750
- 125 = 1.2500
- 137 = 1.3750
- 150 = 1.5000
- 175 = 1.7500
- 200 = 2.0000

#### Custom cam CL

#### Offset (A x B)

- 201 = 1.2500 x 0.2500
- 202 = 1.2500 x 0.5000
- 203 = 1.3750 x 0.2500
- 204 = 1.5000 x 0.1250
- 205 = 1.5000 x 0.2500
- 206 = 1.5000 x 0.3750
- 207 = 1.7500 x 0.3750
- 208 = 2.0000 x 0.2500
- 209 = 2.0000 x 0.5000

### XX = MATERIAL INSTALLED ON

- WD = Wood
- MT = Metal
- GL = Glass

# CAM LOCKS

## WOOD INSTALLATION

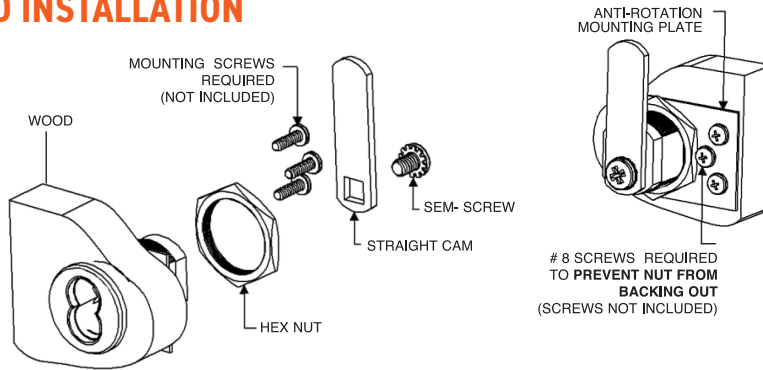

## METAL INSTALLATION

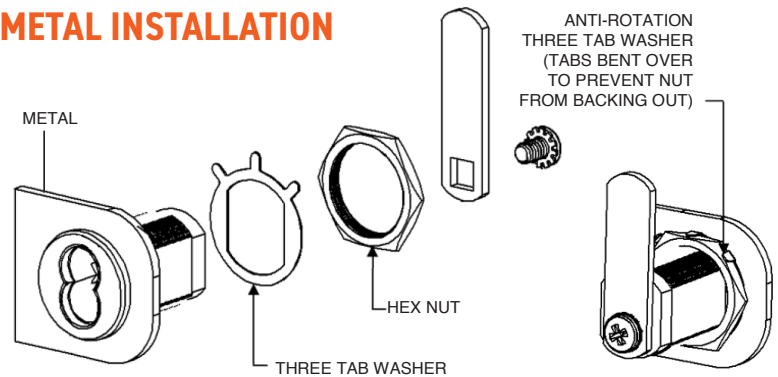

## GLASS INSTALLATION

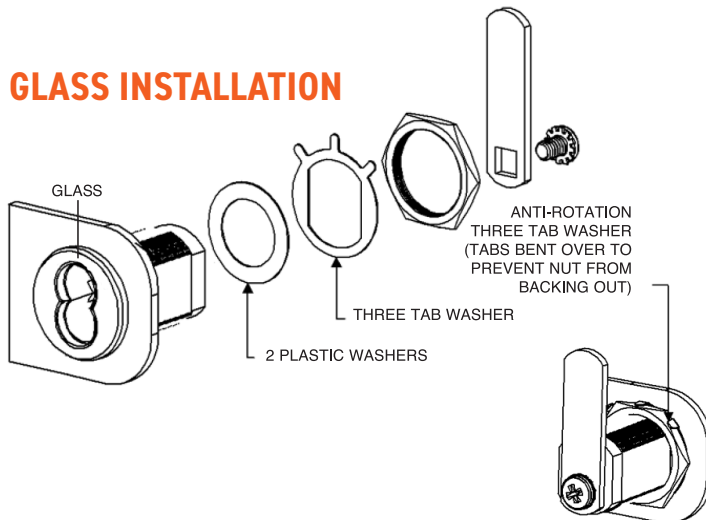

*By contrast to our competitor's SFIC Cam Lock, our patented design SFIC Cam Lock makes installation simple. You tell us how you want the lock prepared (Locked at 9:00 / Open at 12:00, Key Retaining, etc...) and we ship it out to you pre-assembled that way. All you have to do is mount it.*



THEIRS



VS.

OURS

# DEADBOLT & SPRING BOLTS



SFIC Deadbolt and Spring Bolt

Base Part #: **55-DBX** **XXX** **X** **X** **XX**  
**55-SPR** **XXX** **X** **X** **XX**

## RIM MOUNT- VERTICAL DEADBOLT

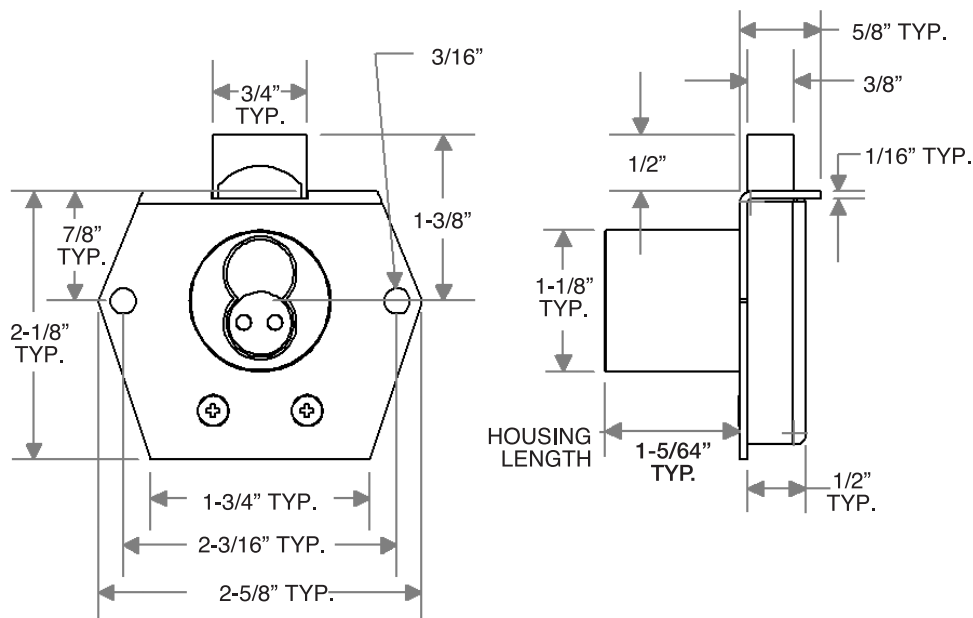

## RIM MOUNT- INVERTED SPRING BOLT

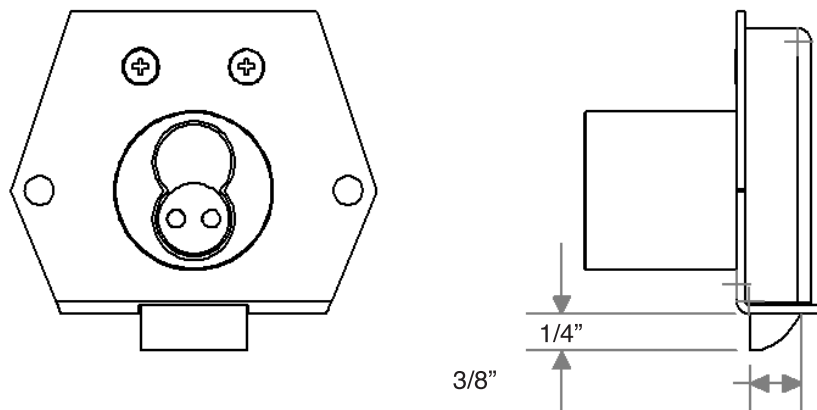



# DEADBOLT & SPRING

## MORTISE MOUNT- RIGHT HAND SPRING BOLT *(special order)*

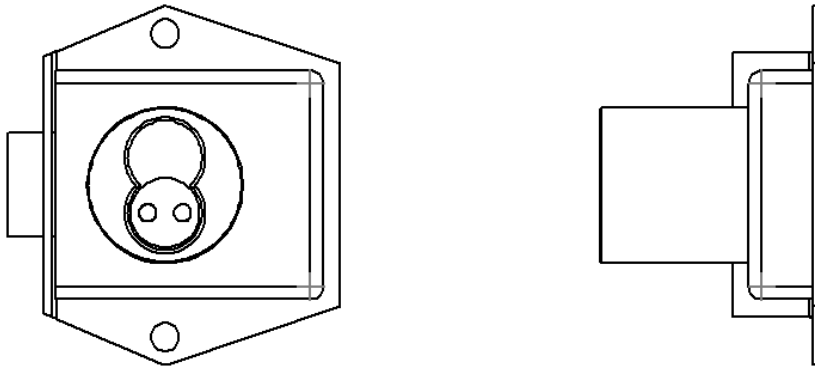

## MORTISE MOUNT- LEFT HAND DEADBOLT *(special order)*

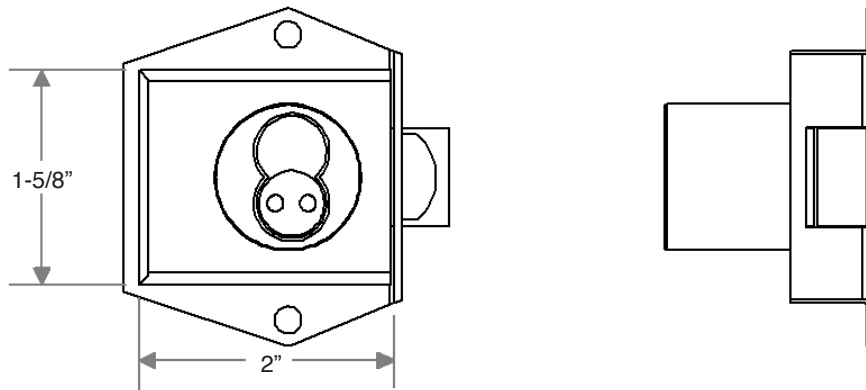

55-DBX **XXX** **X** **X** **X** **XX**

55-SPR **XXX** **X** **X** **X** **XX**

### XXX = BOLT TYPE

DBX = Deadbolt  
SPR = Spring Bolt  
CBX = Cabinet Bolt

### X = MOUNTING

R = Rim  
M = Mortise

### X = BOLT DIRECTION

12:00 = Vertical  
6:00 = Inverted  
3:00 = Left Hand Hinged Door  
(Special Order)  
9:00 = Right Hand Hinged Door  
(Special Order)

### X = KEY FUNCTION

1 = Key Retaining  
2 = Non Key Retaining  
X = Neither really applies

### XX = FINISH

BC = Brushed Chrome  
PC = Polished Chrome  
SB = Satin Brass  
PB = Polished Brass  
ST = Statuary Bronze  
BL = Black  
AB = Antique Bronze

## STRIKES

Part# 00-AC-STR-1620x3900-L-BN

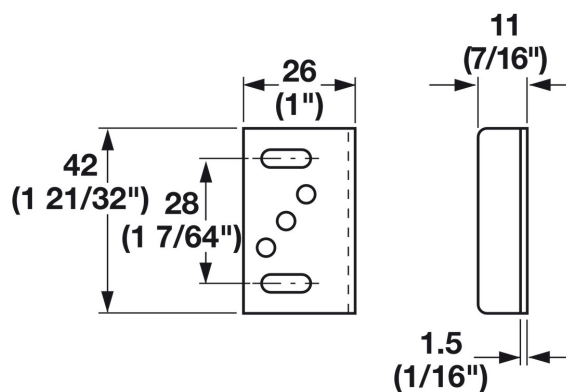

Part# 00-AC-STR-1750x1880-L-BN

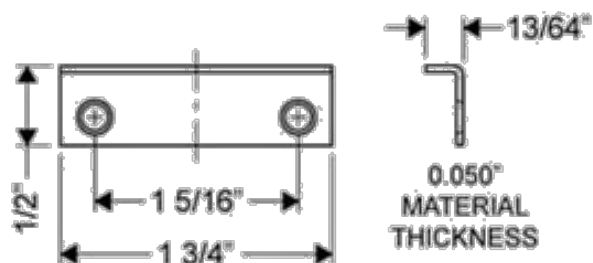

Part# 00-AC-AC-STR-1300x3200-L-BN

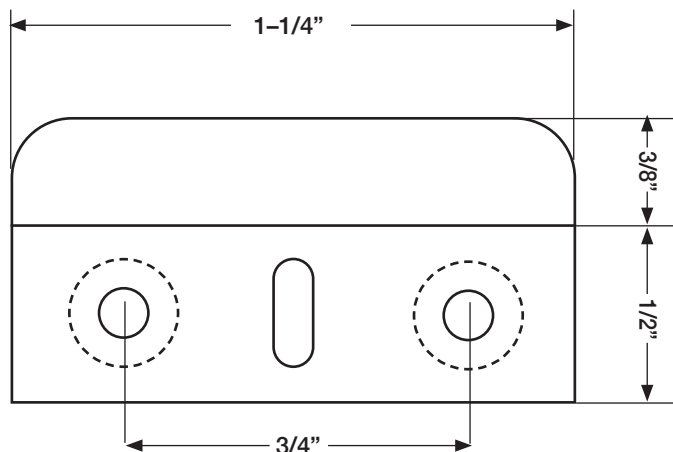
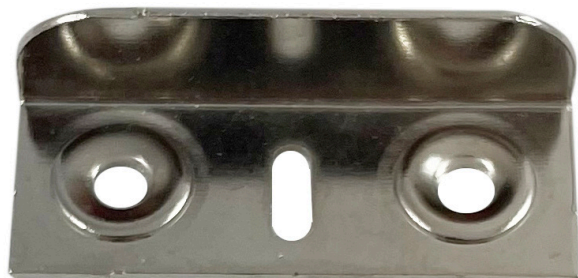

Part# 00-AC-STR-1750x5000-L-BN

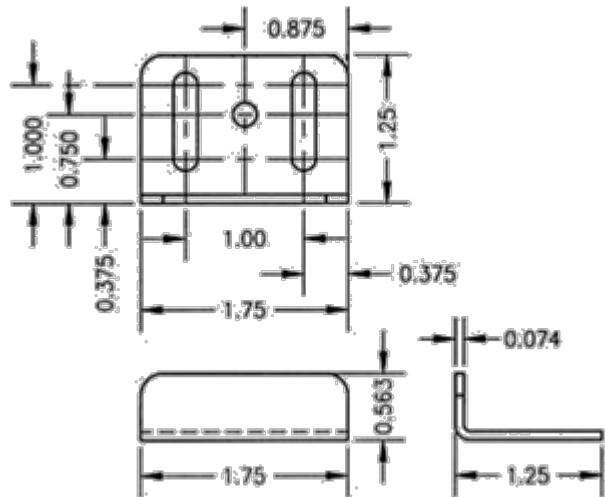

Part# 00-AC-STR-1868x6845-SLT-BN

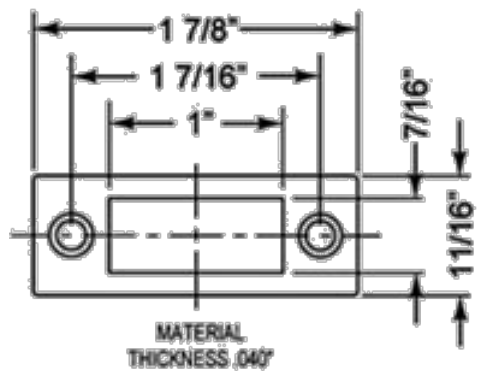

Part# 00-AC-STR-2155x5000-SLT-BN

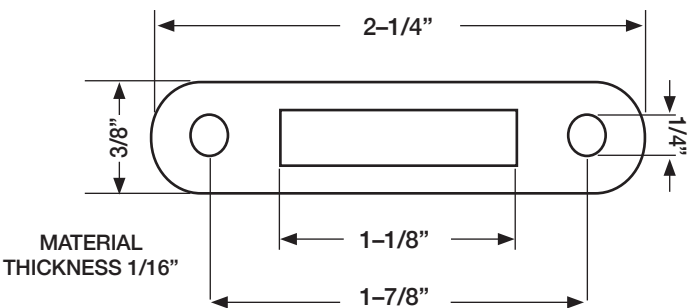

# ACCESSORIES

## STRIKES

Part# 00-AC-STR-1867x6850-SOL-LIP-BN

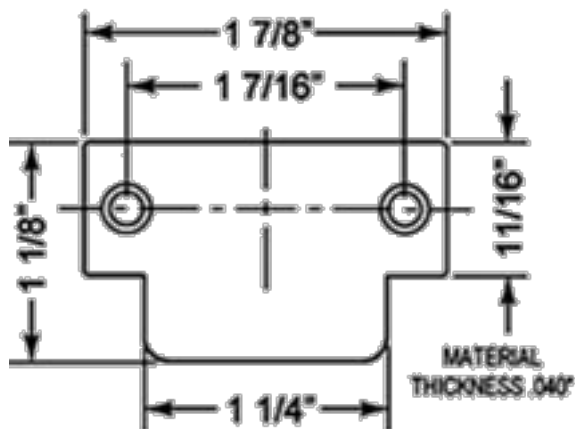

Part# 00-AC-STR-1867x6850-SLT-LIP-BN

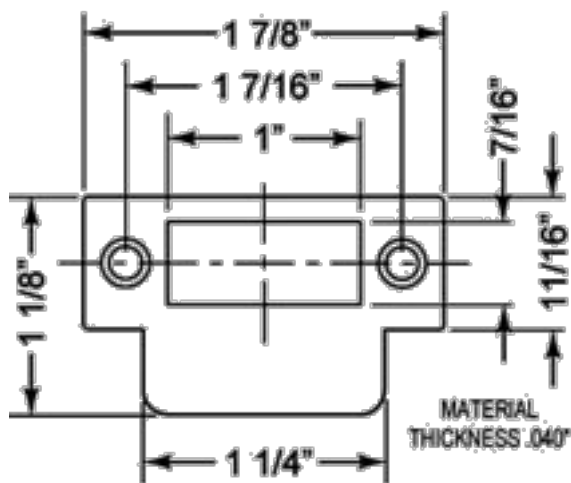

SPACERS

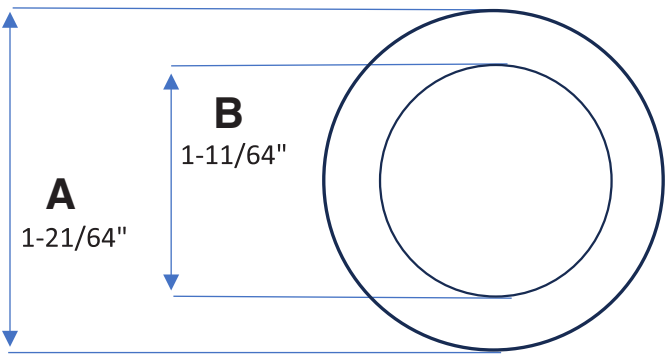

Dim. A and B

Tolerances: +/- 1/16"

Dim. C. Part #:

1/8"	55-AC-SPA-125-AL
3/16"	55-AC-SPA-187-AL
1/4"	55-AC-SPA-250-AL
3/8"	55-AC-SPA-375-AL
1/2"	55-AC-SPA-500-AL



# DEADBOLT



SFIC CBX Deadbolt  
Available with steel or cast bolts.

Base Part #: **55CBX** **XX** **X** **XX**

*“Throw” (distance bolt travels from the locked to unlocked position) is  $23/32$ ”.*

*All dimensions shown are in the locked position.*

12:00

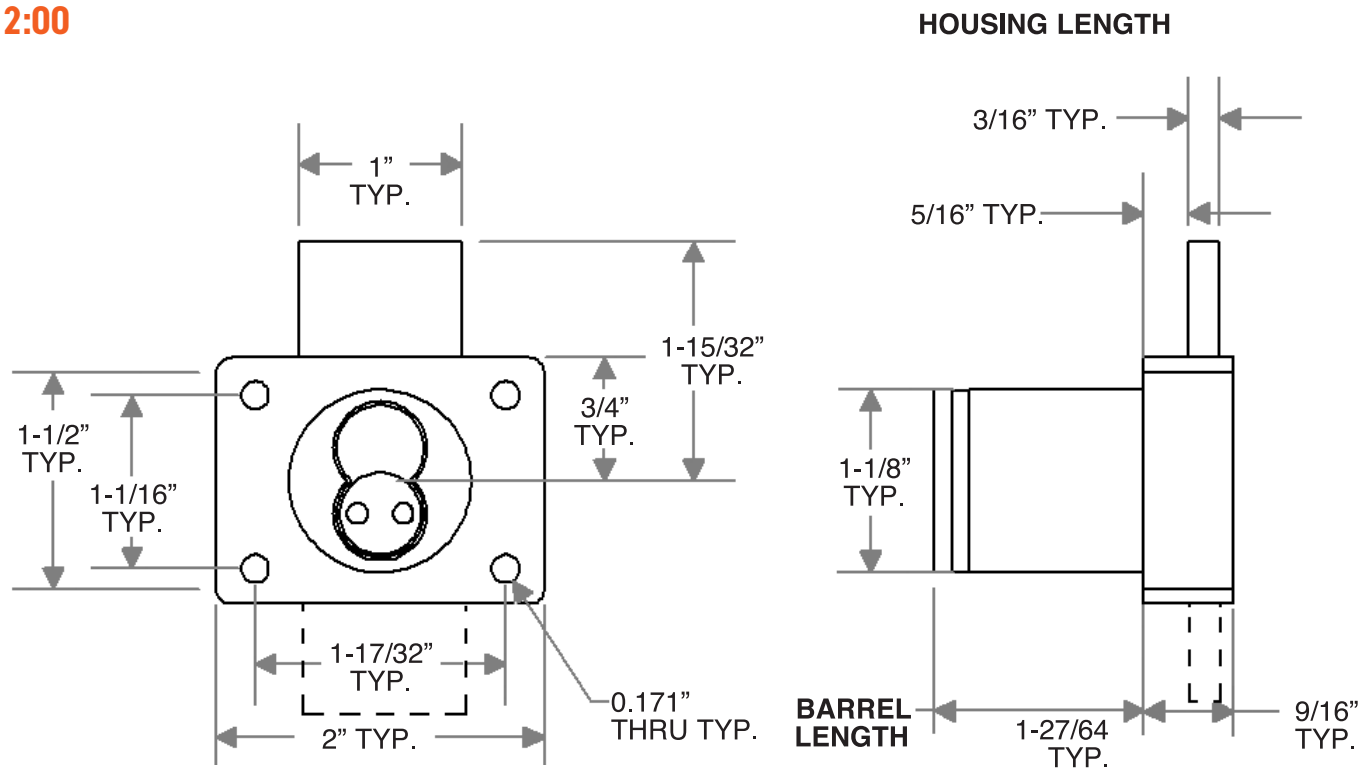

9:00

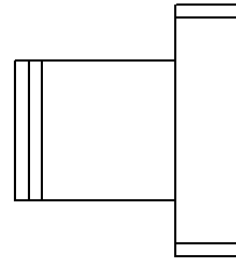
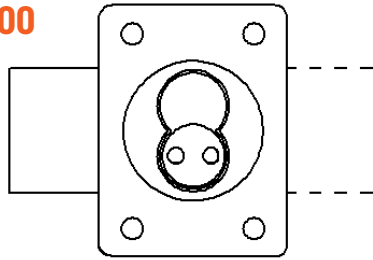

6:00

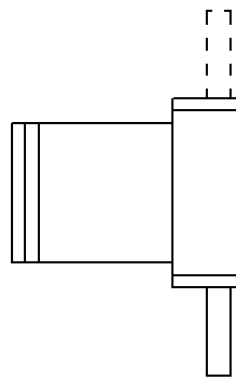
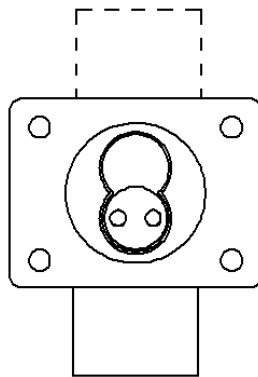

3:00

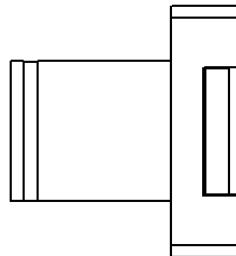
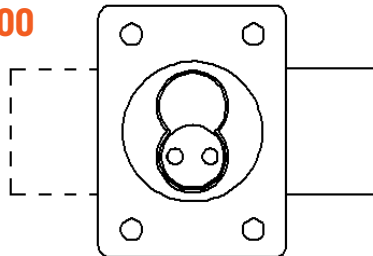

## 55CBX XX X XX

### XX = BOLT LOCKED DIRECTION

12 = 12 O'Clock

03 = 3 O'Clock

06 = 6 O'Clock

09 = 9 O'Clock

### X = KEY FUNCTION

1 = Key Retaining (Standard)

2 = Non Key Retaining

### XX = FINISH

BC = Brushed Chrome (Standard)

PC = Polished Chrome

SB = Satin Brass

PB = Polished Brass

ST = Statuary Bronze

BL = Black

AB = Antique Bronze



# SFIC PLUNGER LOCK-KEY RETAINING



BOA's SFIC Plunger lock with key the retaining feature is built to give you years of trouble-free service due to the direct drive bolt and which enables a smooth operation.

Keys and Cores sold separately.

Base Part#: **55 PL SD X 1 BC**

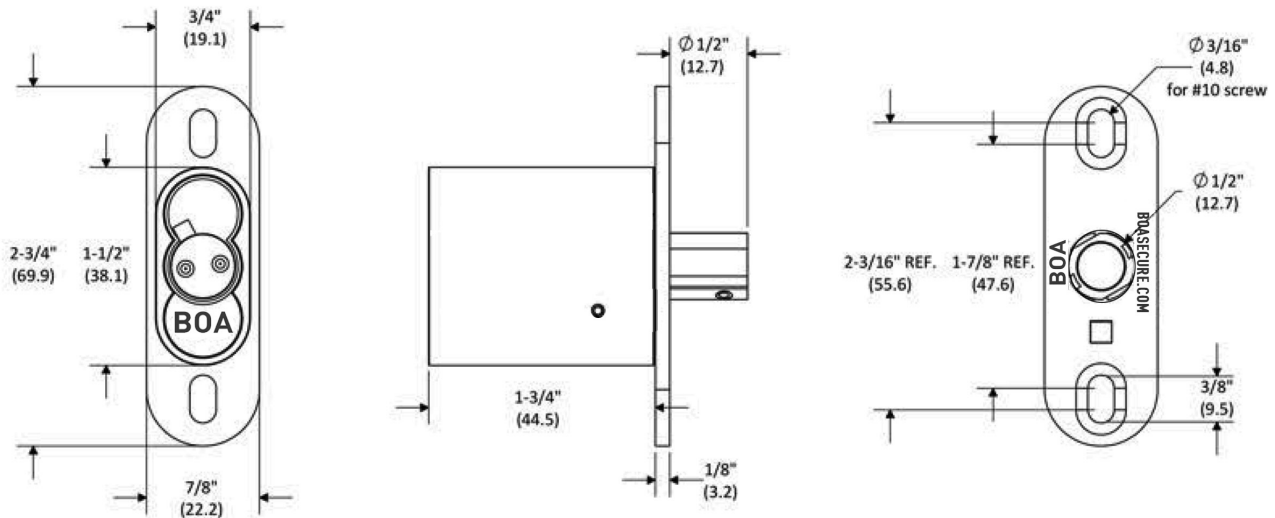

\* Parenthesis dimensions are in mm.



**55 PL SD X 1 BC**

## OPTIONAL SUPPORT PLATE

**55 PL SP BC**

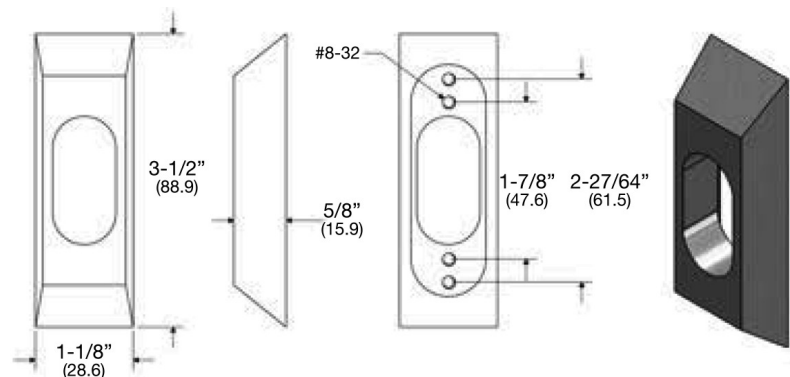



# SFIC PLUNGER LOCK-NON KEY RETAINING



BOA's SFIC Plunger lock with our non-key retaining feature is built on the foundation of a pad-lock; utilizing the built to last ball-bearing foundation. It will provide years of trouble-free service. Furthermore, the Prong Pins are well secured in the up-right position to ensure smooth insertion of the cores when needed.

Keys and Cores sold separately.

Base Part#: **55 PL SD X 2 BC**

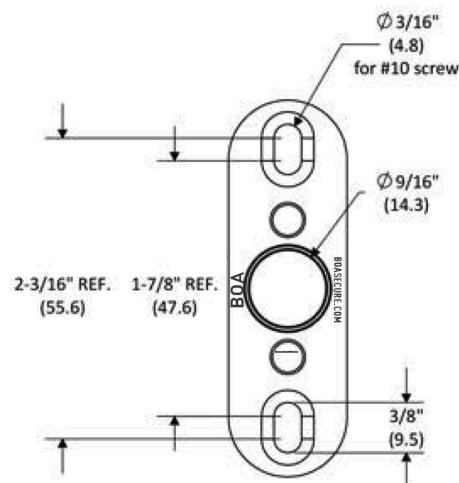
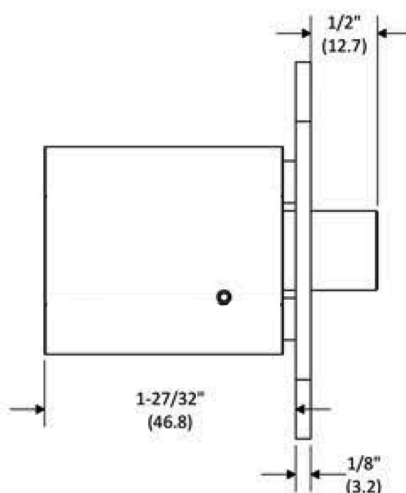
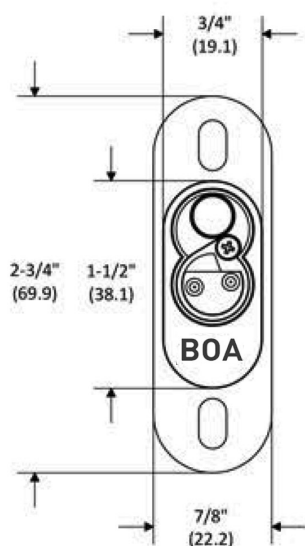

\* Parenthesis dimensions are in mm.

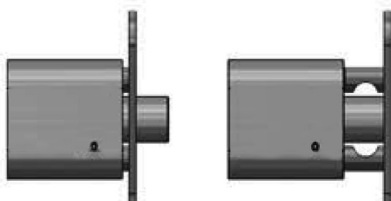

**55 PL SD X 2 BC**

## OPTIONAL SUPPORT PLATE

**55 PL SP BC**

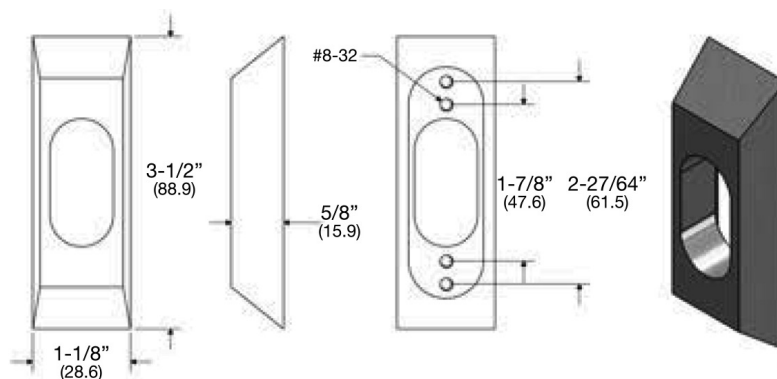

# MEDICAL CART/FILE CABINET LOCK



BOA's SFIC Medical Cart / Medical Cabinet lock is a direct replacement for the BEST 2P73. As with all of our SFIC products, it accepts all major manufacturer's Small Format Interchangeable Cores (BEST style). This product is built to provide years of trouble-free service due to our stainless-steel spring-loaded locking pin and Prong Driver Assembly. The spring loaded bolt provides just the right amount of tension for a perfectly smooth action when rotating the key. Our lock comes standard with a Red-Dot indicator to let you know when the lock is in the unlocked position.

Base Part#: **55 SPR FCV X BC**

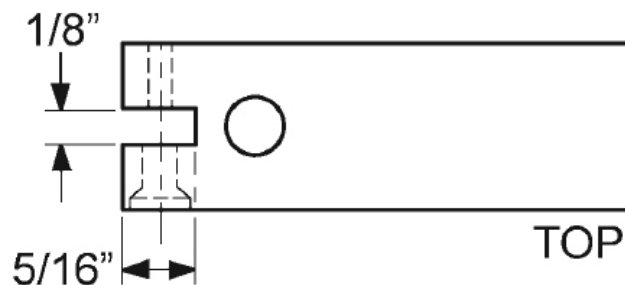
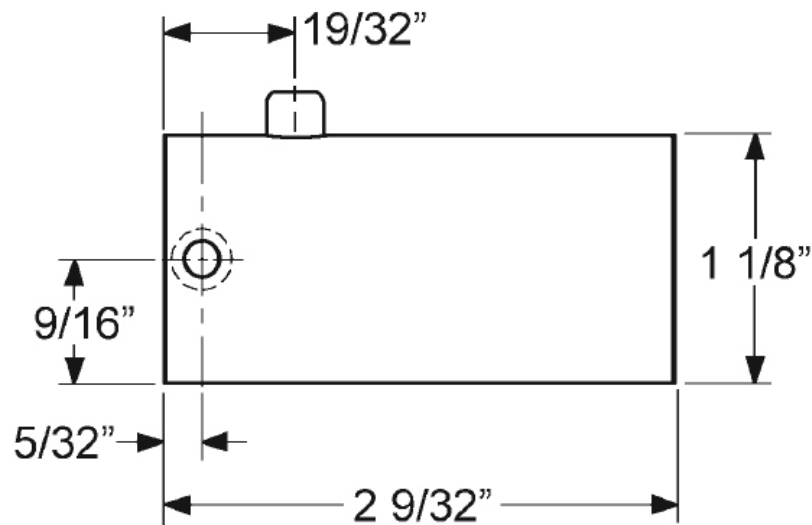
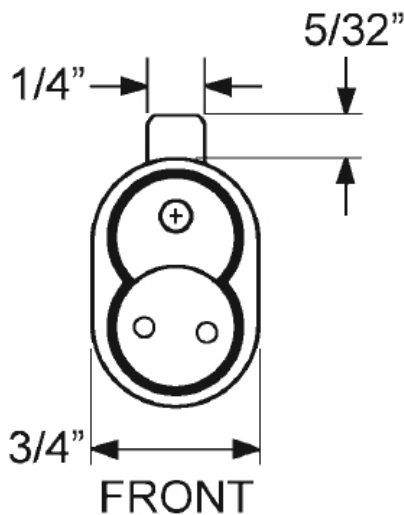

# SFIC RATCHET



The BOA SFIC Ratchet lock is made with a forward facing core for ease of use. This lock has six different mounting bars available. The lock is made with an optional spacer in order to accommodate a variety of applications.

Keys and Cores sold separately.

Base Part#: **55 RT XXXX**

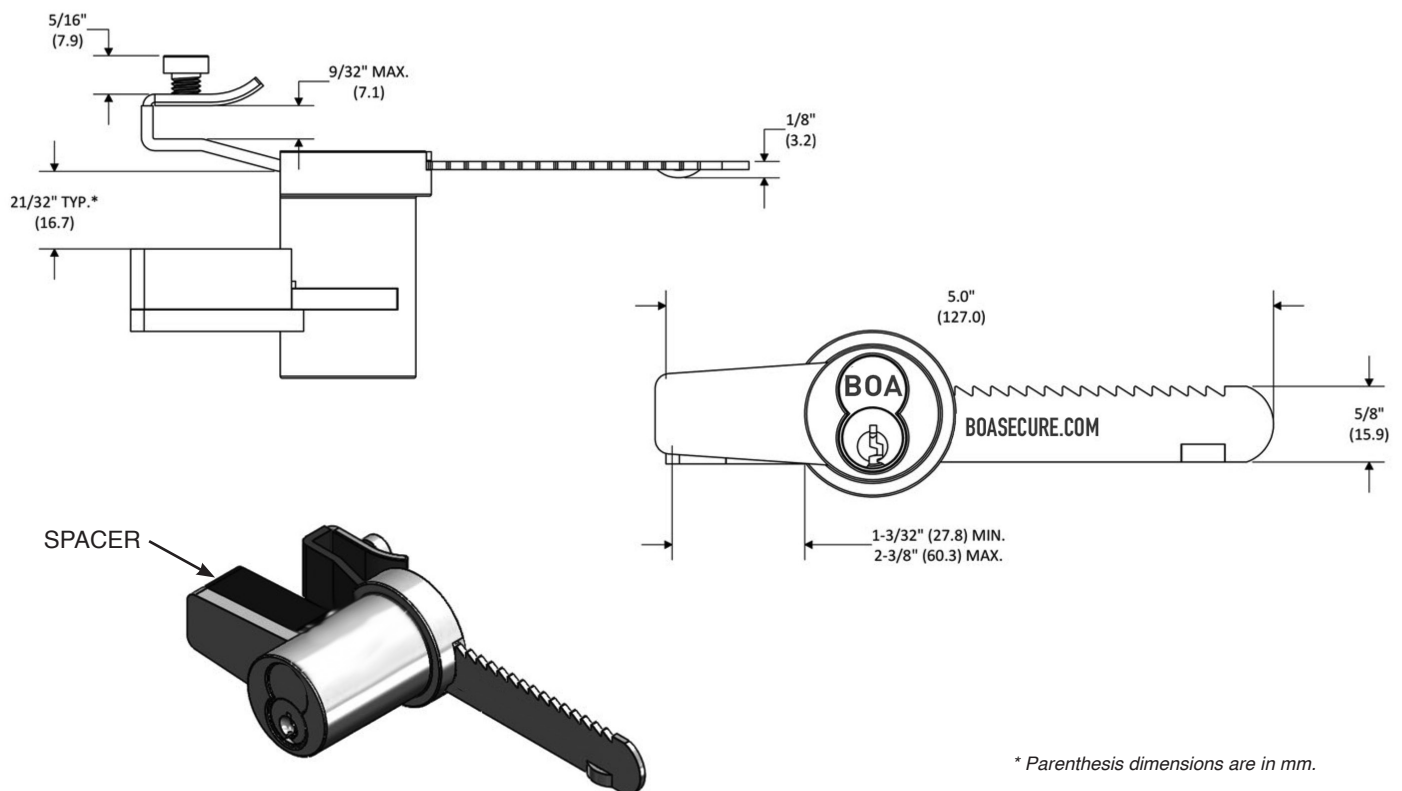

\* Add 1/2" when removing the plastic adjustable option

## 55 RT XXXX

### XXXX = RATCHET BARS

R250 = Regular Ratchet Bar for glass doors with a max thickness of 1/4"

R375 = Regular Ratchet Bar for glass doors with a max thickness of 3/8"

A750 = Extended Ratchet Bar for glass doors with a max thickness of 3/4"

RADH = Small adhesive mounted plate (1-1/2" x 2")

RADE = Large adhesive mounted plate (1-1/2" x 3-7/8")

R500 = Short Ratchet Bar for thick material

# SFIC RATCHET BARS



**R250**  
Small Ratchet Bar 1/4"

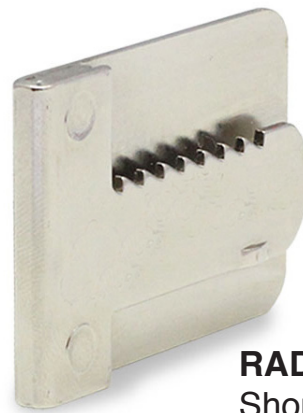

**RADH**  
Short Ratchet Plate  
1-1/2" x 2"



**R375**  
Regular Ratchet Bar 3/8"



**RADE**  
Long Ratchet Plate  
1-1/2" x 3-7/8"



**R750**  
Extended Ratchet Bar 3/4"



**R500**  
Short Ratchet Bar  
for thick material



## Mortise Cylinder

Base Part#: 55 CYL MORT 1250 **XX**



## Tapered Mortise

Base Part#: 55 CYL MORT 875 **XX**

## MORTISE CYLINDER WITH CHANGEABLE CAM

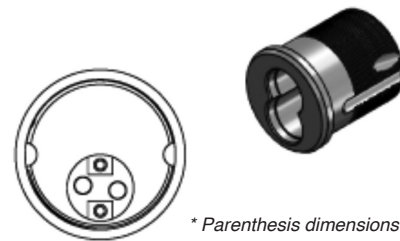
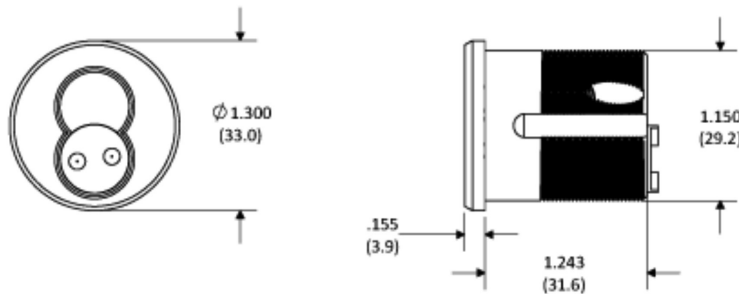

\* Parenthesis dimensions are in mm.

## TAPERED MORTISE WITH CHANGEABLE

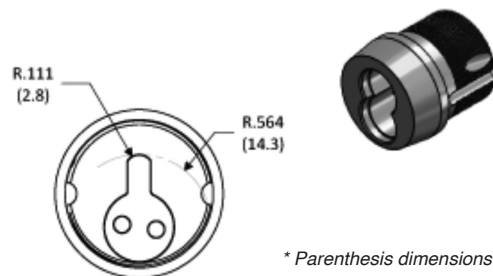
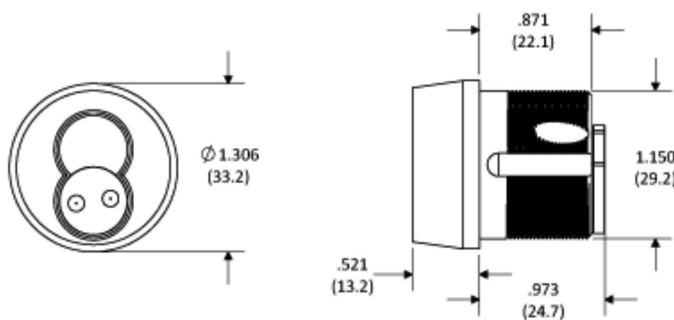

\* Parenthesis dimensions are in mm.

## CAMS



Z01

Z02

Z06

Z07

## XX = FINISH

BC = Brushed Chrome (Standard)

PC = Polished Chrome

SB = Satin Brass

PB = Polished Brass

ST = Statuary Bronze

BL = Black

AB = Antique Bronze

# CYLINDERS



## Rim Cylinder

Base Part#: 55 CYL RIM **XX**

\* Parenthesis dimensions are in mm.

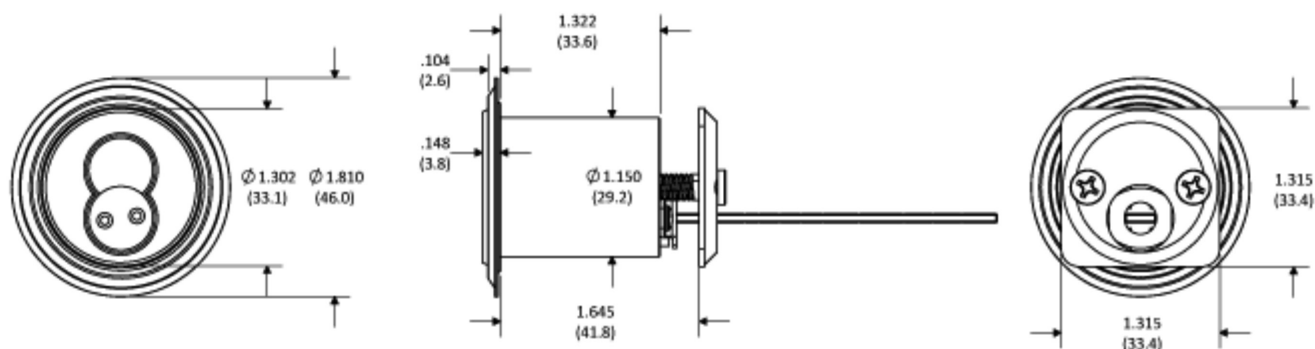

Part#: 55 CYL RIM **XX**

### **XX = FINISH**

BC = Brushed Chrome (Standard)

PC = Polished Chrome

SB = Satin Brass

PB = Polished Brass

ST = Statuary Bronze

BL = Black

AB = Antique Bronze





**BOA SECURITY TECHNOLOGIES**

**586 New York Avenue, Unit 3**

**Huntington, NY 11743**

**T 516-576-0295 | F 631-470-8099**

**Alan.Lurie@BOA-ST.com**

**[www.BoaSecure.com](http://www.BoaSecure.com)**

BOA is also a BEST distributor.

If you require original BEST locks to meet bid specifications we will be happy to provide them to you.

Catalog design by Morehaus Designs LLC.